

FS-AOI Insert compatible with Age of Innovation®



Assembly Instructions

The package contains seven sheets: 1 double and 5 single sheets.

After assembly the trays are put in up to three layers in the original game box.

Ordinary PVA glue is required when assembling each tray.

Please make sure you dry-assemble each tray correctly before gluing it together.

Please check www.foldedspace.com for general assembly tips.

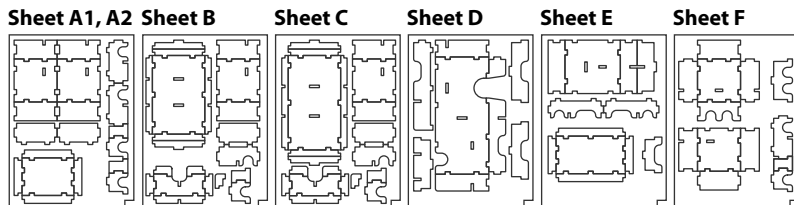
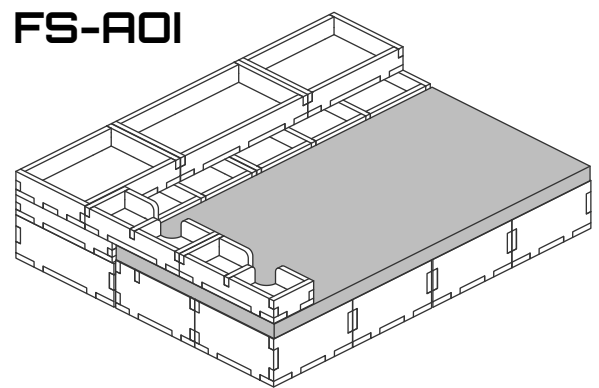

Tray 1a, 1b, 2

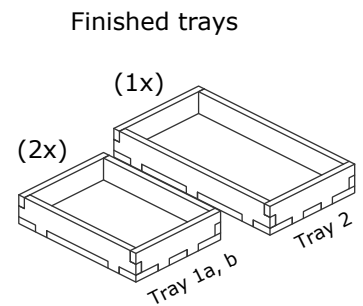
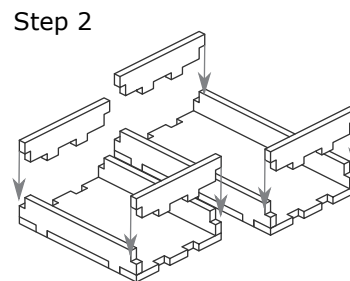
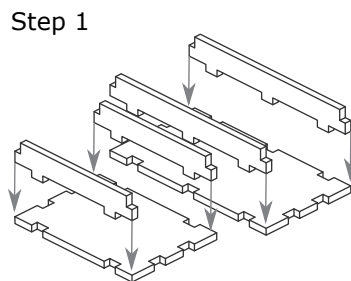
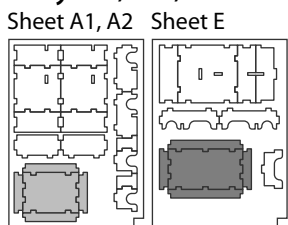

Tray 3a, 3b

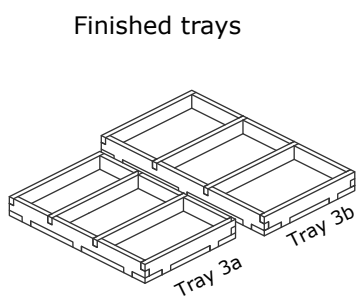
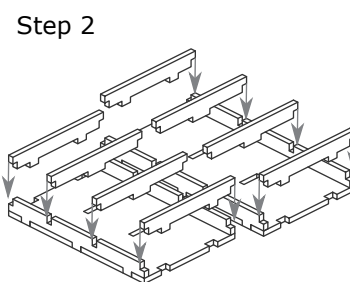
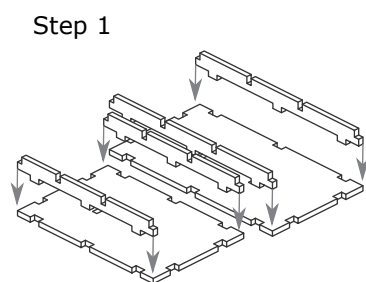
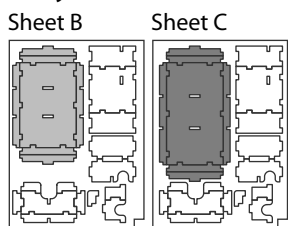

Tray 4a, 4b (the trays are identical)

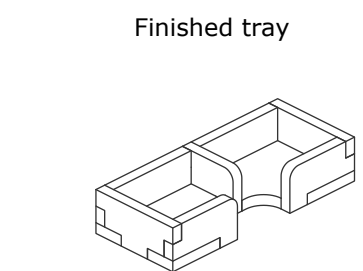
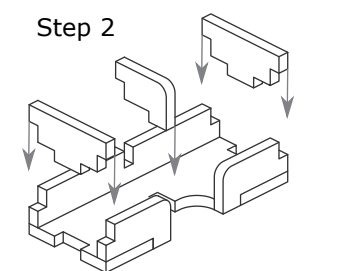
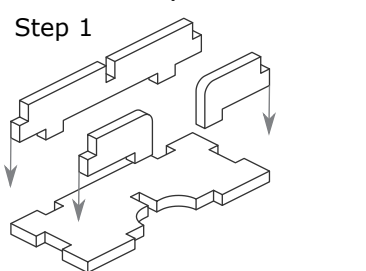
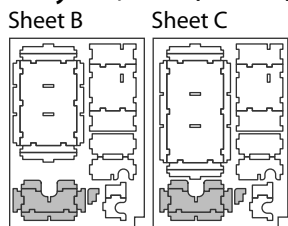

Tray 5

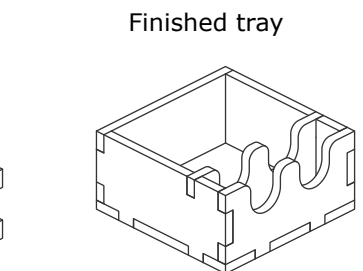
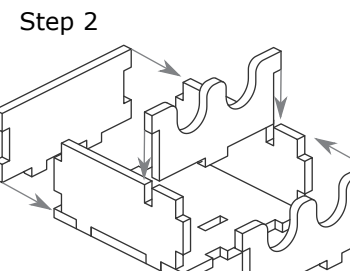
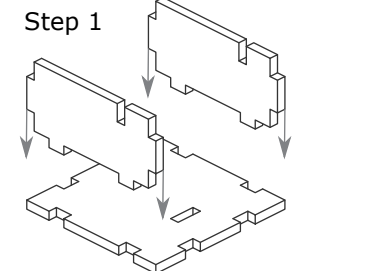
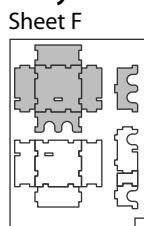

FS-AOI Insert compatible with Age of Innovation®

Tray 6a, b, c, d, e, f, g (the trays are identical)

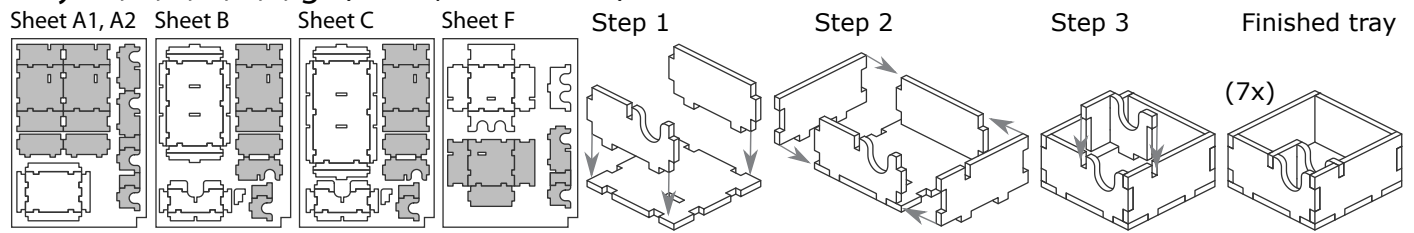

Tray 7

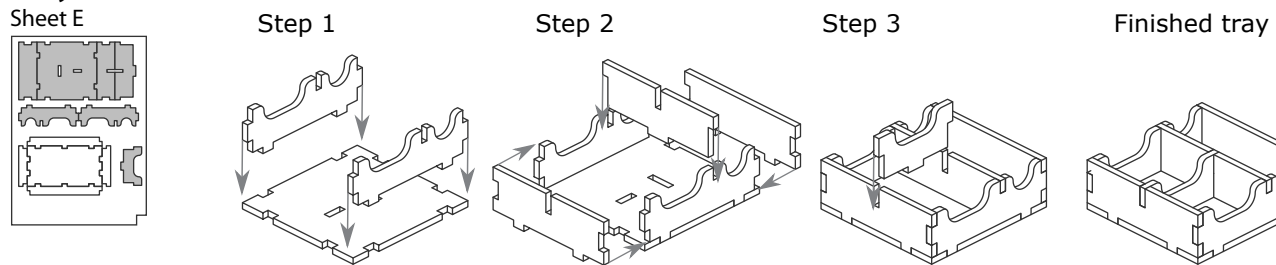

Tray 8

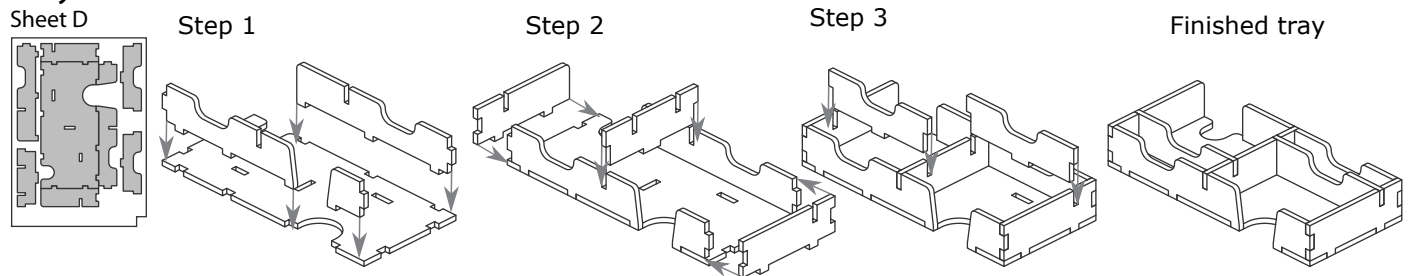

FS-AOI

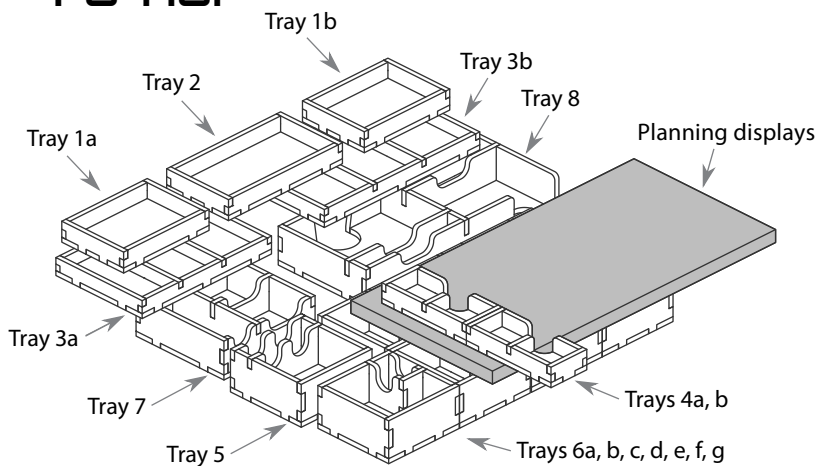

Please check www.foldedspace.com for photos of this insert in use.

Tray legend

- Tray 1a - book action and round score tiles
- Tray 1b - automa tiles and tokens
- Tray 2 - tool cubes
- Tray 3a - power tokens, X tokens, and city tiles
- Tray 3b - coins
- Tray 4a, b - books
- Tray 5 - starting competency tiles and neutral wooden bits
- Tray 6a, b, c, d, e, f, g - player pieces
- Tray 7 - innovation, palace and regular competency tiles
- Tray 8 - game cards, faction tiles and round bonus tiles

Note: each player tray (Trays 6) has space for eight terrain tiles of the matching colour. Should you need more than this during the game just take from the other trays not in use in this game.