

FS-SEPT Insert compatible with Septima[©] including the Shapeshifting & Omens[®] expansion



Assembly Instructions

The package contains four single sheets.

After assembly the trays are put in up to two layers in the original game box.

Ordinary PVA glue is required when assembling each tray.

Please make sure you dry-assemble each tray correctly before gluing it together.

Please check www.foldedspace.com for general assembly tips.

FS-SEPT

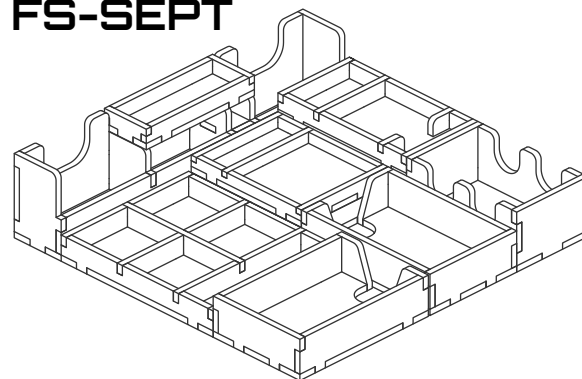

Sheet 1

Sheet 2

Sheet 3

Sheet 4

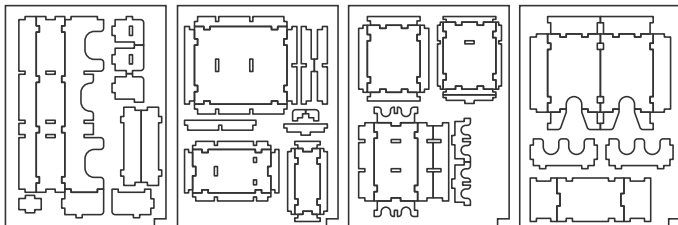

Tray 1

Sheet 2

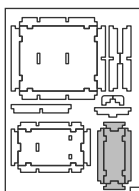

Step 1

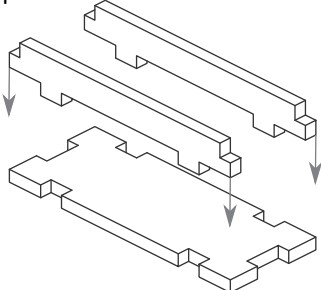

Step 2

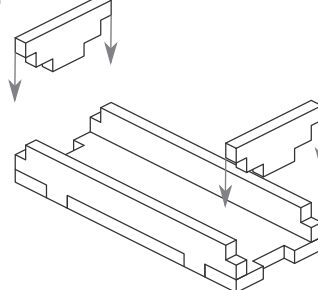

Finished tray

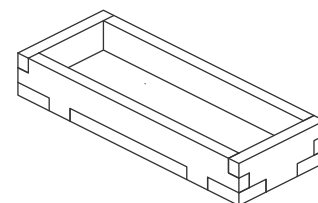

Tray 2a, 2b

Sheet 3

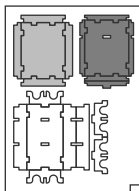

Step 1

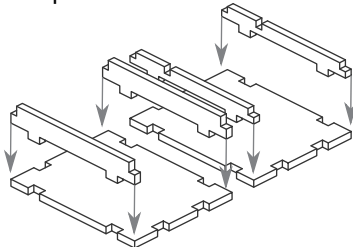

Step 2

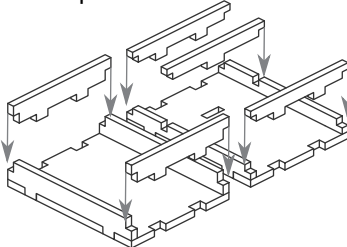

Finished trays

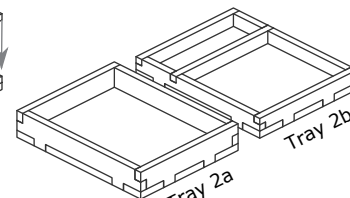

Tray 3a, 3b (the tray builds are identical)

Sheet 1

Sheet 4

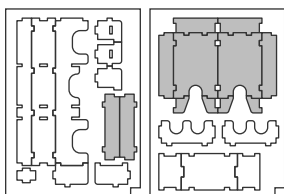

Step 1

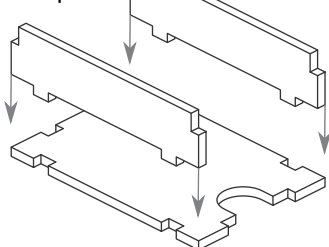

Step 2

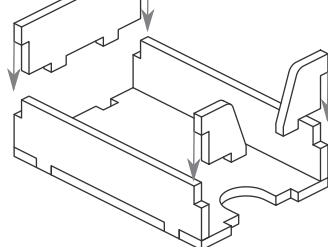

Finished tray

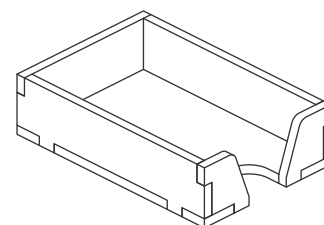

Tray 4

Sheet 2

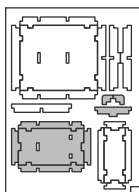

Step 1

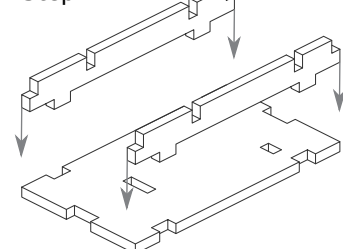

Step 2

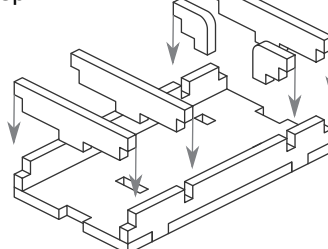

Finished tray

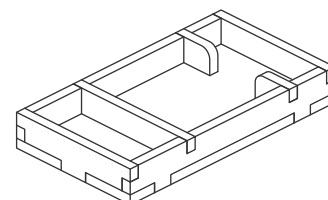

FS-SEPT Insert compatible with Septima[©] including the Shapeshifting & Omens[®] expansion



Tray 5

Sheet 4

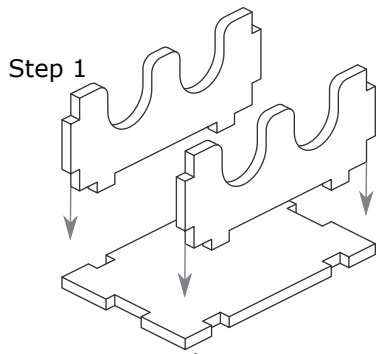
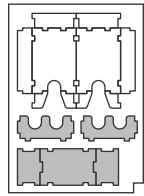

Step 2

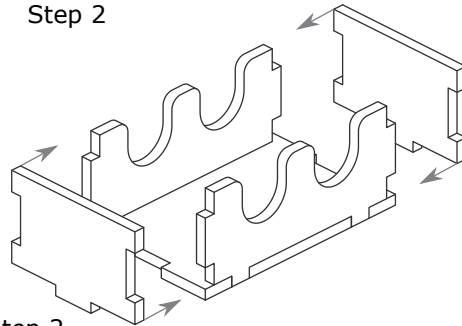

Finished tray

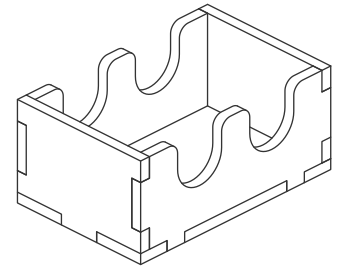

Tray 6

Sheet 3

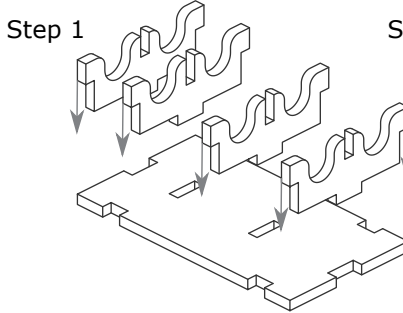
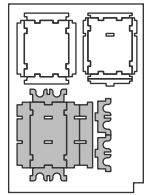

Step 2

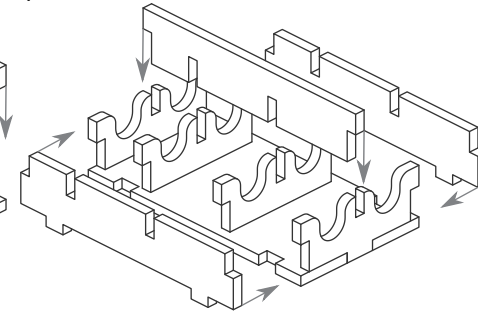

Finished tray

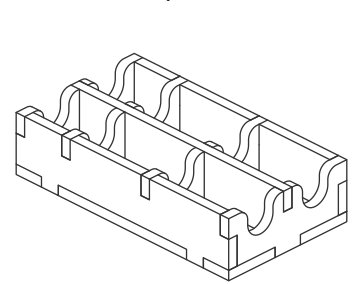

Tray 7

Sheet 2

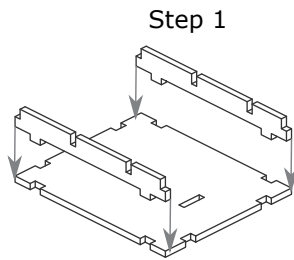
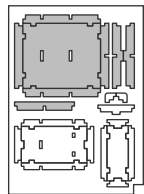

Step 1

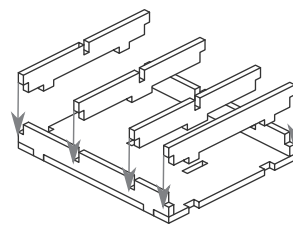

Step 2

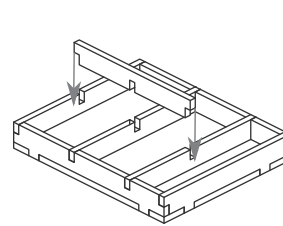

Finished tray

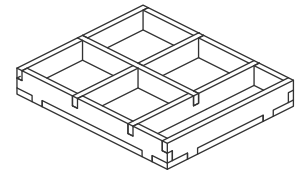

Tray 8

Sheet 1

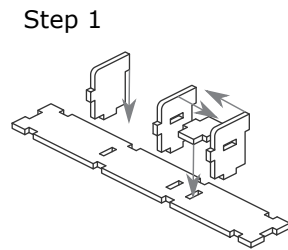
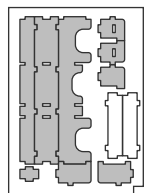

Step 1

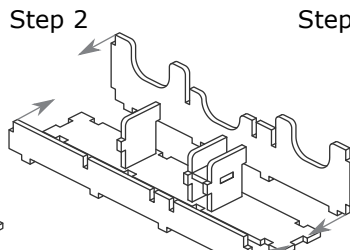

Step 2

Step 3

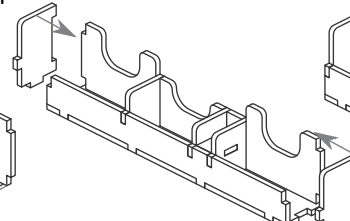

Finished tray

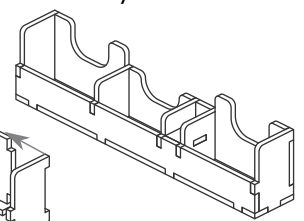

FS-SEPT

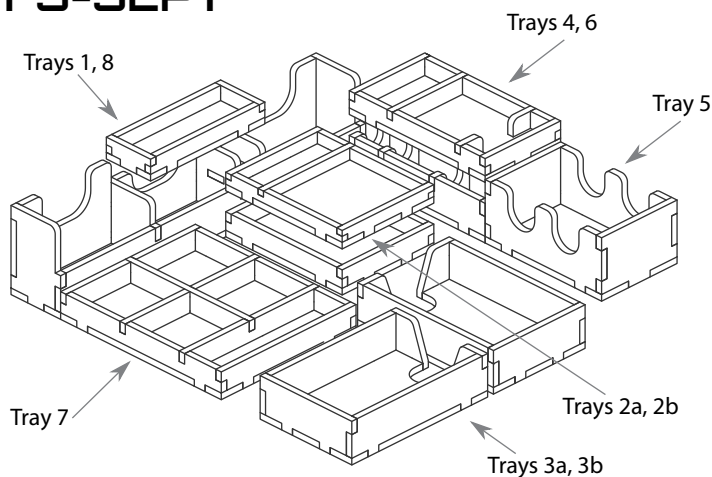

Please check www.foldedspace.com for photos of this insert in use.

Tray legend

- Tray 1 - starting player token, lunar ingredient markers, patient tokens, and season, moon phase & turn step markers
- Tray 2a - wisdom tokens
- Tray 2b - good luck charm tokens and angry citizen meeple
- Tray 3a - action cards
- Tray 3b - omen, book of divination, and black widow action cards
- Tray 4 - crystals, building tiles, and spell & septima action markers
- Tray 5 - potion tokens
- Tray 6 - ingredient tokens
- Tray 7 - player pieces, and hunter & spider pawns
- Tray 8 - small cards, dice, and witch & animal tiles

Note: the trial bag, scoring pad, and scoring aid sheets are placed on top of tray 7.

Tip: Keep the instructions in the bottom of your board game box as a reminder of how the insert fits together.