

# FS-ARCCB Insert compatible with Architects of the West Kingdom®: Collector's Box, including Age of Artisans®, Works of Wonder®, and promo player boards



## Assembly Instructions

The package contains 5 sheets: two double and one single sheet.  
After assembly the trays are put in up to two layers in the original game box.  
Ordinary PVA glue is required when assembling each tray.  
Please make sure you dry-assemble each tray correctly before gluing it together.  
Please check [www.foldedspace.com](http://www.foldedspace.com) for general assembly tips.

### FS-ARCCB

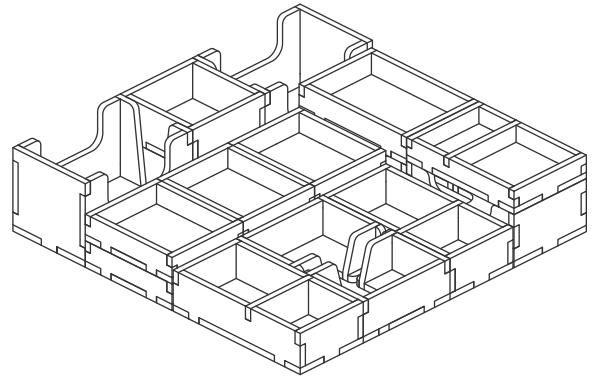

#### Sheet 1 & 2    Sheet 3 & 4    Sheet 5

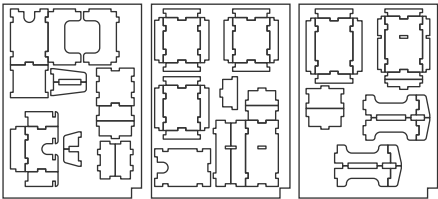

#### Tray 1a, 1b

Sheet 1 & 2

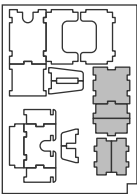

(the trays are identical)

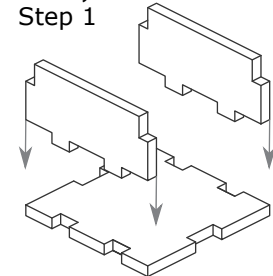

Step 2

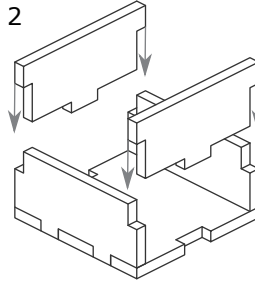

Finished tray

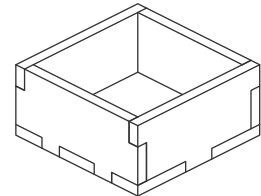

#### Tray 2

Sheet 5

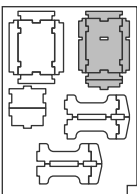

Step 1

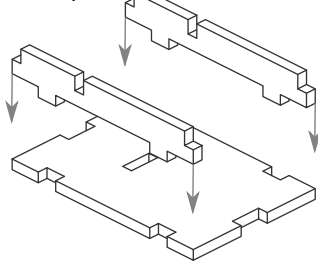

Step 2

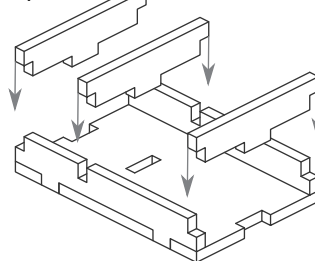

Finished tray

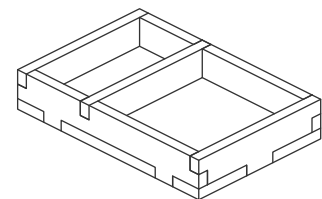

#### Tray 3a, 3b

Sheet 1 & 2

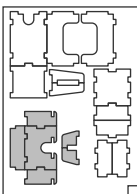

(the trays are identical)

Step 1

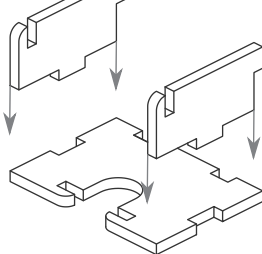

Step 2

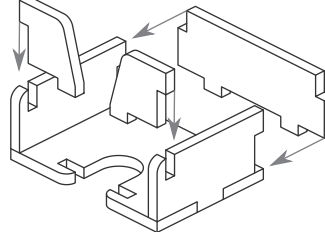

Finished tray

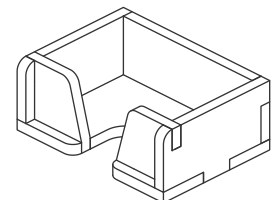

#### Tray 4a, 4b

Sheet 3 & 4

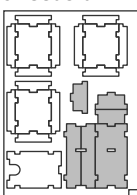

(the trays are identical)

Step 1

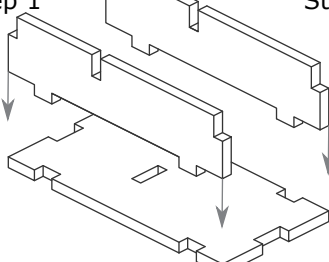

Step 2

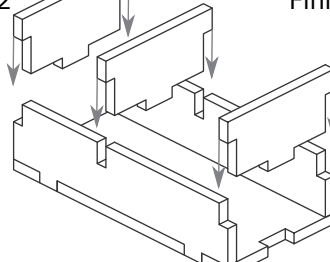

Finished tray

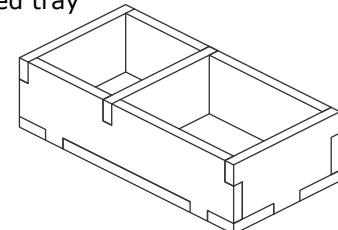

# FS-ARCCB Insert compatible with

## Architects of the West Kingdom®: Collector's Box, including Age of Artisans®, Works of Wonder®, and promo player boards



### Tray 5a, 5b (the trays are identical)

Sheet 1 & 2

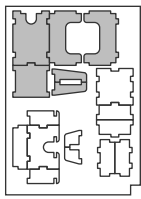

Step 1

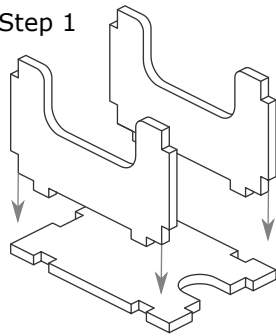

Step 2

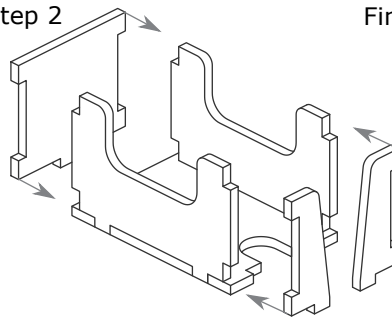

Finished tray

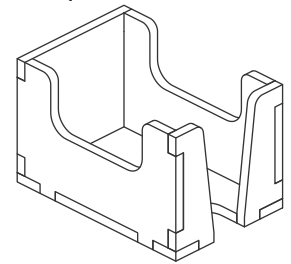

### Tray 6a-6f, 7

Sheet 3 & 4 Sheet 5

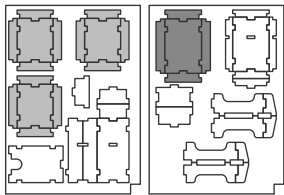

(trays 6a-6f are identical)

Step 1

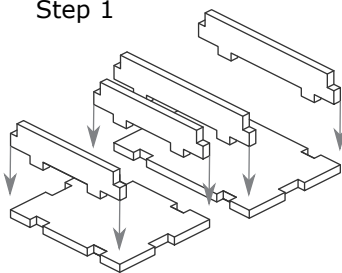

Step 2

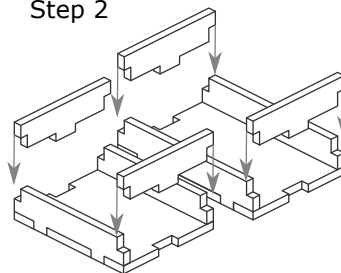

Finished trays

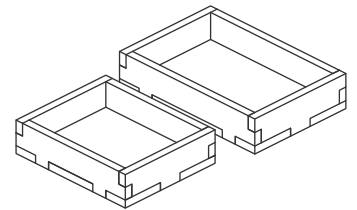

### Tray 8a, 8b

(Tray 8a pieces marked with ★, and Tray 8b pieces marked with ●)

Sheet 3 & 4

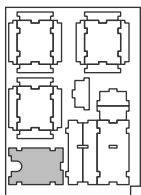

Step 1

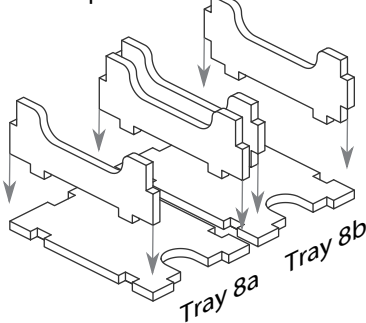

Step 2

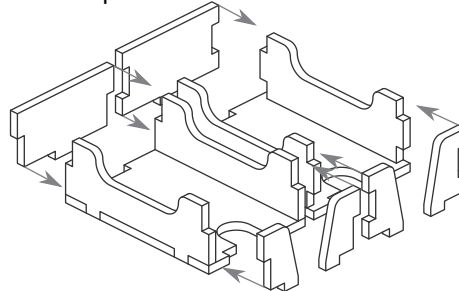

Finished trays

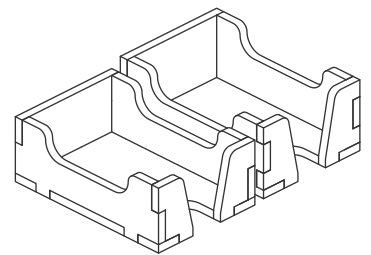

Sheet 5

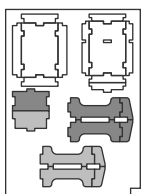

## FS-ARCCB

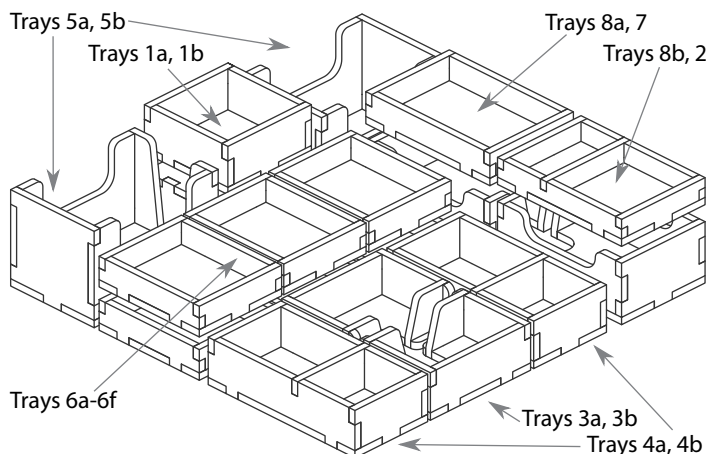

Please check [www.foldedspace.com](http://www.foldedspace.com) for photos of this insert in use.

### Tray legend:

- Tray 1a, b - silver coins
- Tray 2 - wood and princess, profiteer, & resource markers
- Tray 3a - reward & black market cards
- Tray 3b - debt & multiplier cards
- Tray 4a, b - clay & gold, and stone & marble
- Tray 5a - apprentice cards
- Tray 5b - building cards
- Tray 6a, b, c, d, e, f - player pieces
- Tray 7 - wonder tokens
- Tray 8a - craft, black market overlay, wonder & contribution/consequence cards
- Tray 8b - solo scheme card decks

Note: the player boards are placed in the recess on top of Trays 3 and 4.