

FS-PALCB Insert compatible with the Paladins of the West Kingdom®: Collector's Box, including the base game contents and City of Crowns® expansion

Assembly Instructions

The package contains 5 sheets: two double and one single sheet.
 After assembly the trays are put in up to two layers in the collector's box.
 Ordinary PVA glue is required when assembling each tray.
 Please make sure you dry-assemble each tray correctly before gluing it together.
 Please check www.foldedspace.com for general assembly tips.
 The part marked in Sheet 4 is to be discarded.

FS-PALCB

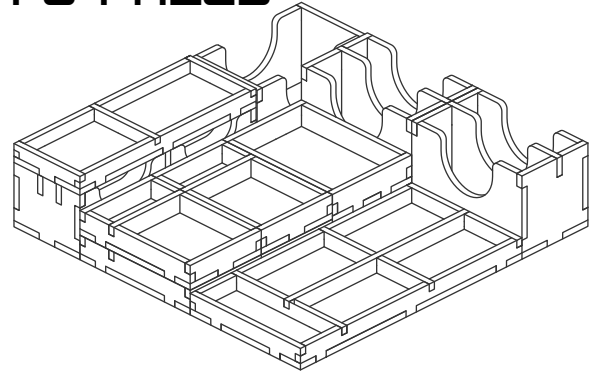

Sheet 1 & 4 Sheet 2 & 5 Sheet 3

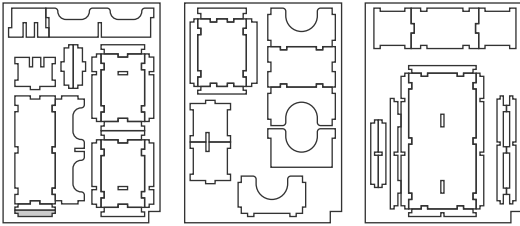

Tray 1

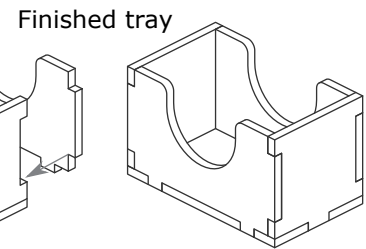
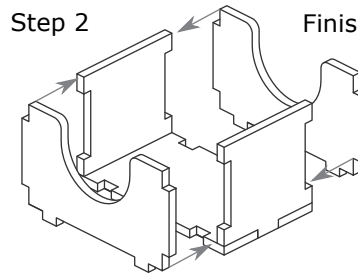
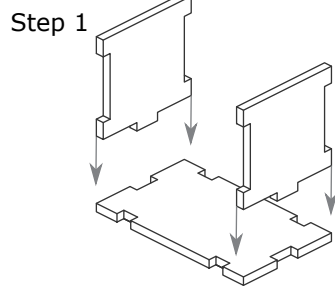
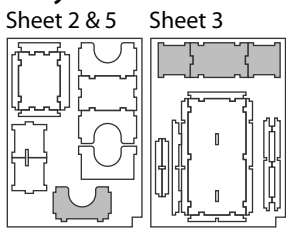

Tray 2a, 2b, 2c, 2d (the tray dimensions are identical)

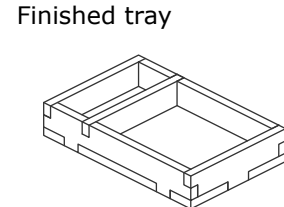
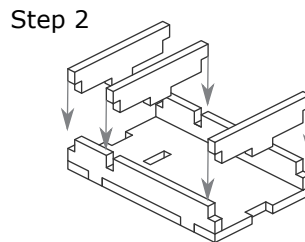
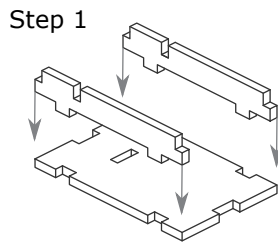
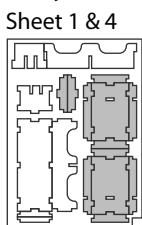

Tray 3

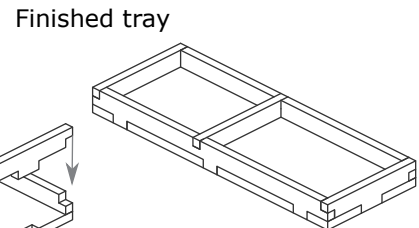
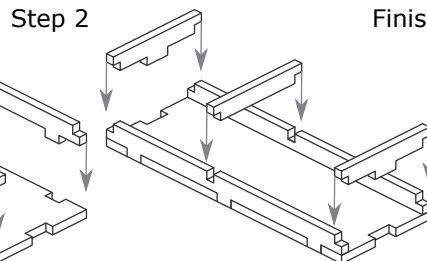
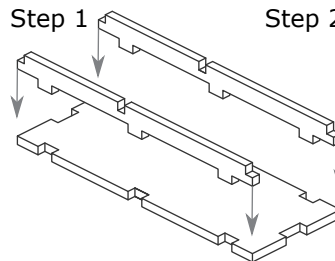
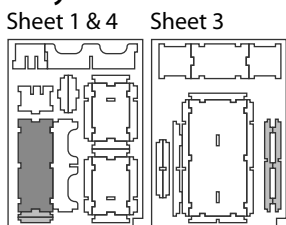

Trays 4a, 4b

(Tray 4a pieces marked with ★, and Tray 4b pieces marked with ●)

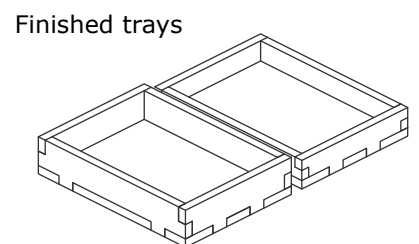
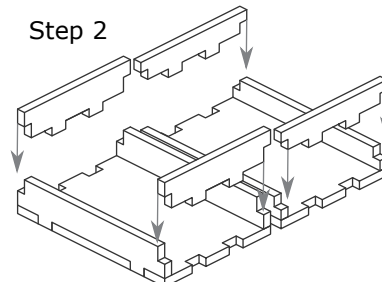
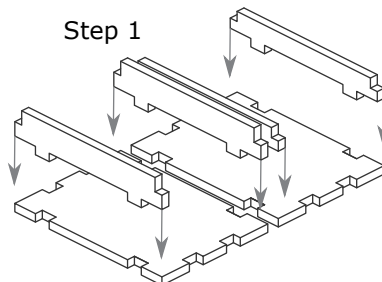
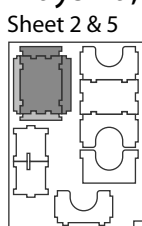

FS-PALCB Insert compatible with the Paladins of the West Kingdom®: Collector's Box, including the base game contents and City of Crowns® expansion



Trays 5a, 5b

Sheet 2 & 5

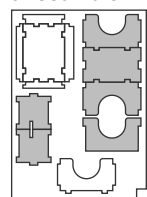

(the tray dimensions are identical)

Step 1

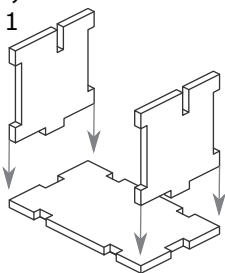

Step 2

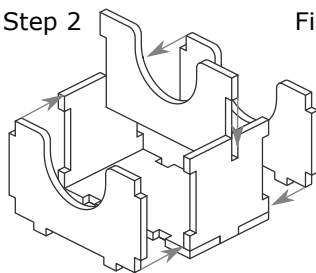

Finished tray

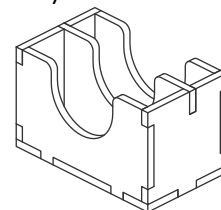

Tray 6

(Note: the tavern and muster card slots in the tray are wider than the other slots, so take care to arrange the end walls and middle divider according to the printed design on the base)

Sheet 1 & 4

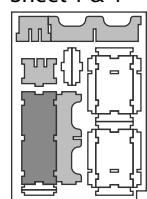

Step 1

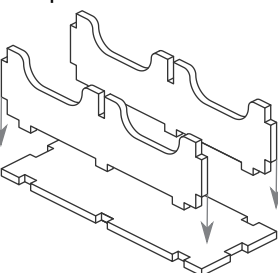

Step 2

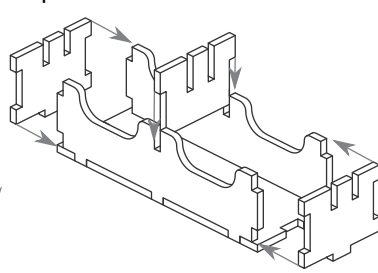

Step 3

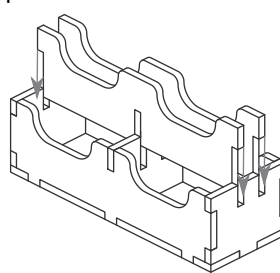

Finished tray

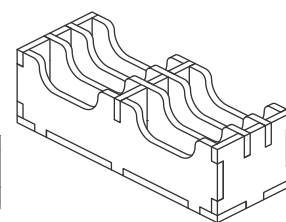

Tray 7

Sheet 3

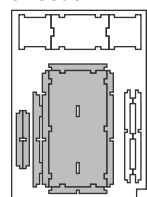

Step 1

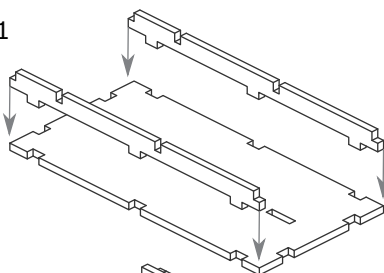

Step 2

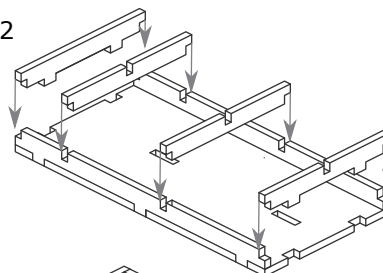

Step 3

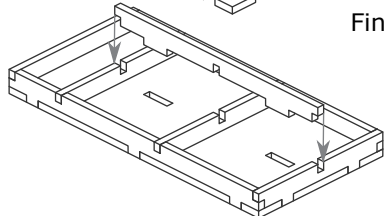

Finished tray

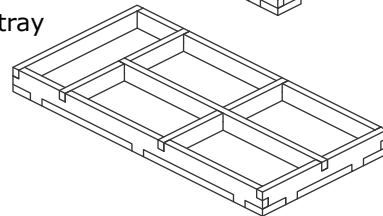

FS-PALCB

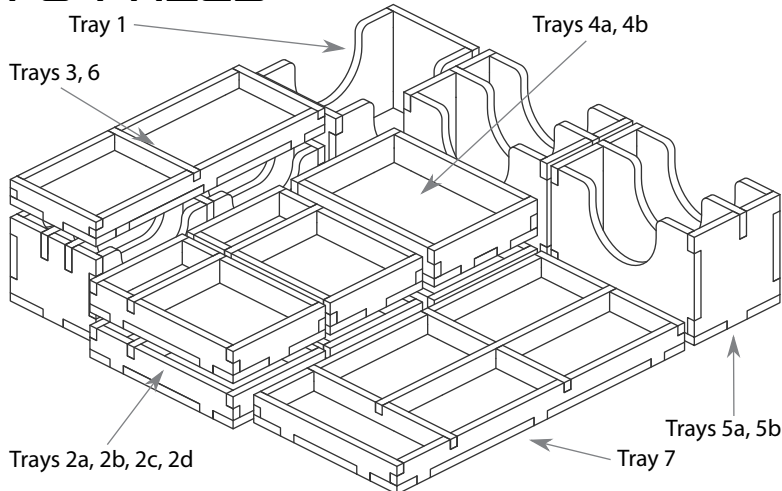

Please check www.foldedspace.com for colour photos of this insert in use.

Tray legend:

- Tray 1 - paladin cards
- Tray 2a, b, c, d - player trays
- Tray 3 - clerics and labourers
- Tray 4a - silver coins
- Tray 4b - provision tokens
- Tray 5a - outsider cards, and scheme cards, ally cards, & start player marker
- Tray 5b - townsfolk and negotiate cards
- Tray 6 - tavern, muster, wall, suspicion, debt and king's order & favour cards
- Tray 7 - scouts, merchants, fighters, criminals, and vassals, diplomat & resource marker

Note: the small main board extension is placed on top of Tray 1. The remaining main board pieces are placed on top of Tray 7 together with the player board extensions. This will leave a level platform for the other boards and rule books to go on top.