

FS-WOTR insert

compatible with War of the Ring: Second Edition®

incl. the Lords of Middle Earth® and Warriors of Middle Earth® expansions



Assembly Instructions

FS-WOTR

The package contains 7 sheets, three identical to the other three and one different sheet.

After assembly the trays are put in three layers in the original game box.

Ordinary PVA glue is required when assembling each tray.

Please make sure you dry-assemble each tray correctly before gluing it together.

Please check www.foldedspace.net for general assembly tips.

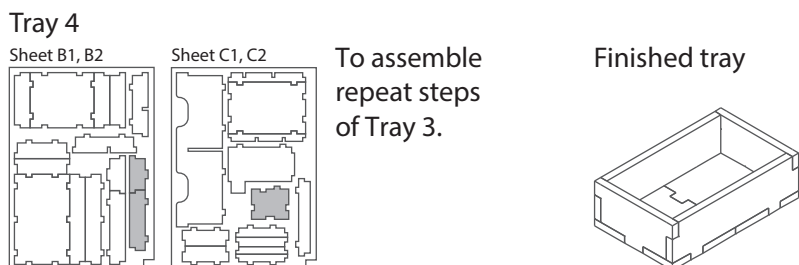
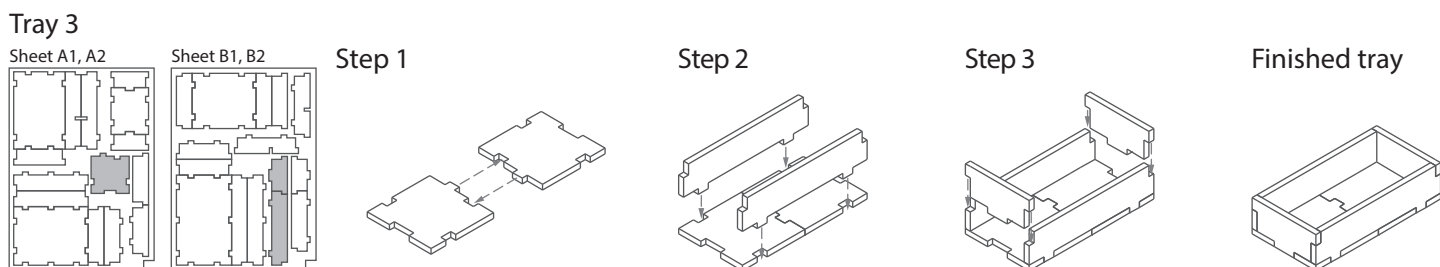
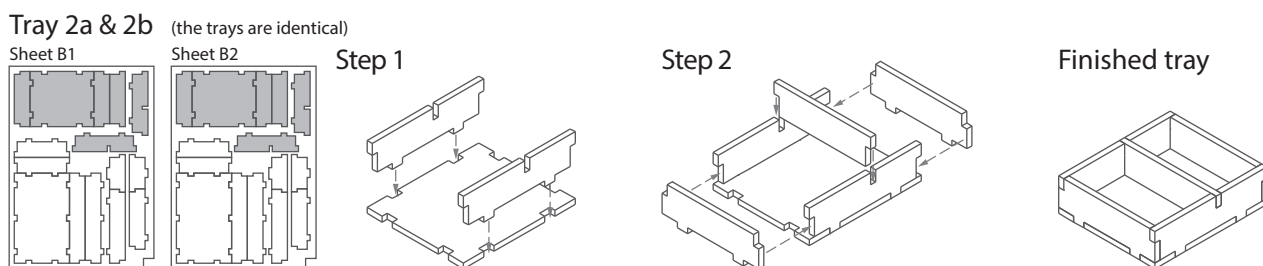
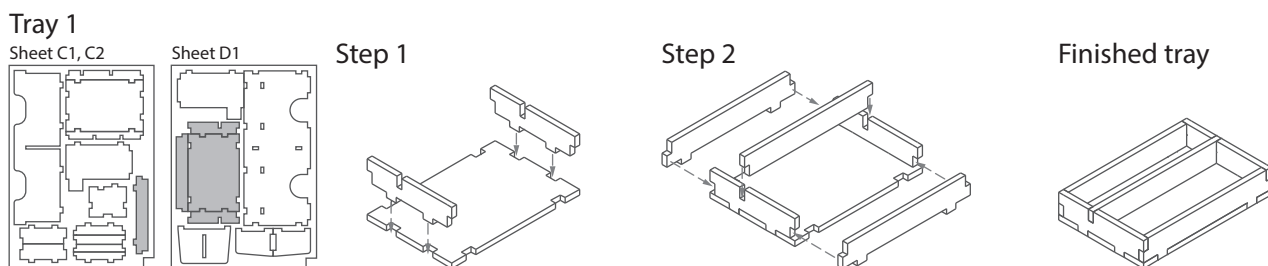
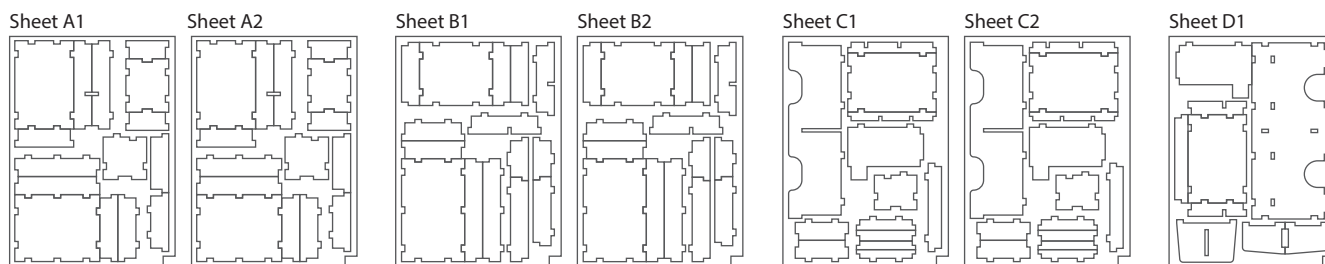
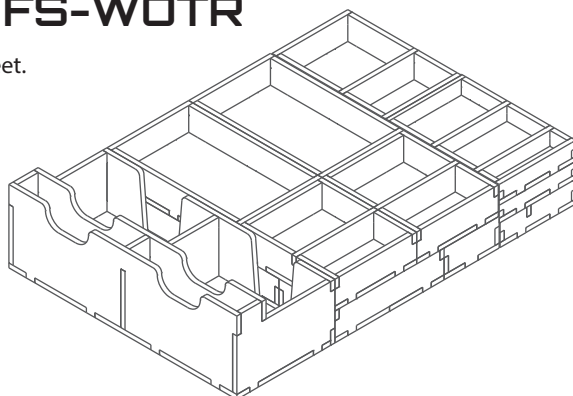

FS-WOTR insert compatible with War of the Ring: Second Edition®

incl. the Lords of Middle Earth® and Warriors of Middle Earth® expansions



Tray 5a & 5b (the trays are identical)

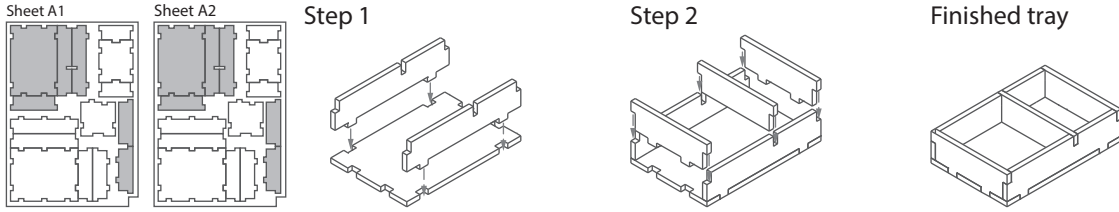

Tray 6a

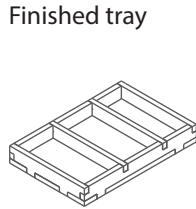
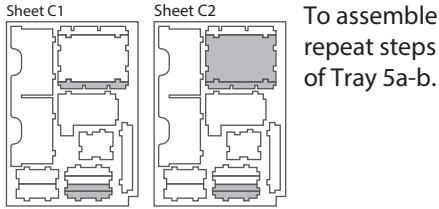

Tray 6b

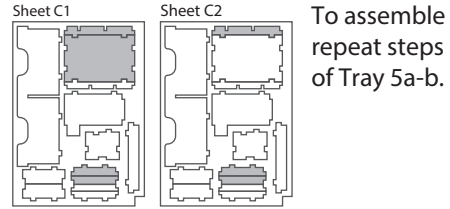

Tray 7a & 7b (the trays are identical)

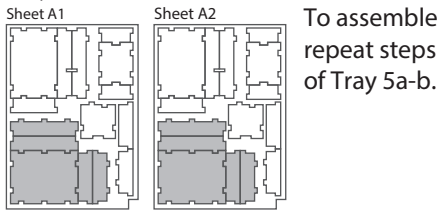

Tray 8a & 8b (the trays are identical)

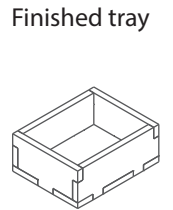
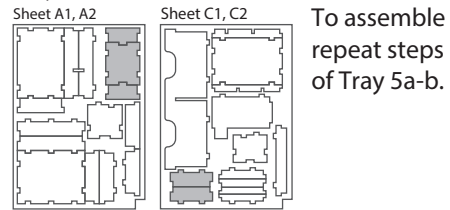

Tray 9a & 9b (the trays are identical)

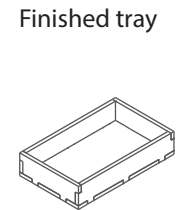
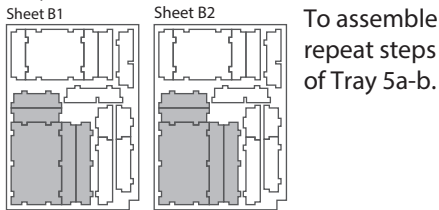

Tray 10

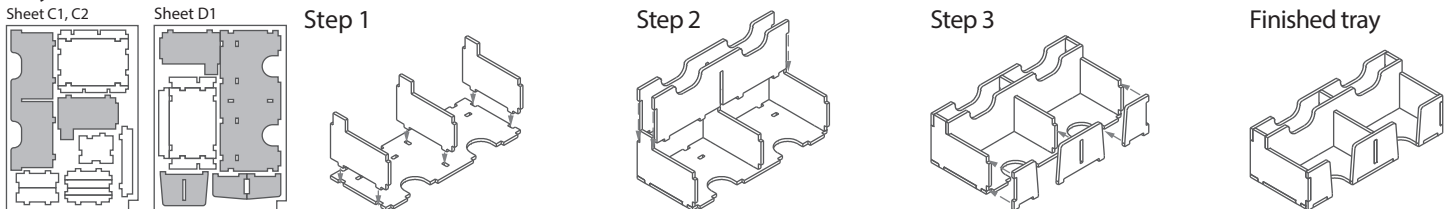

FS-WOTR

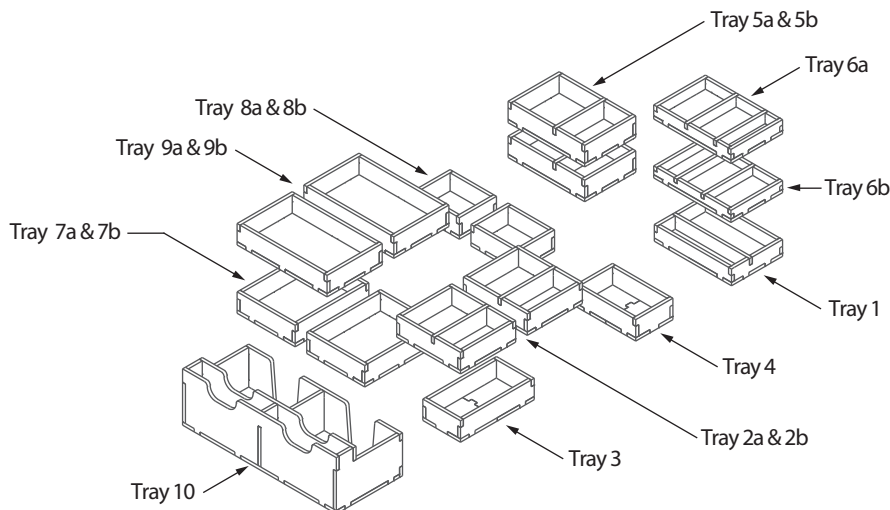

Please check www.foldedspace.net for photos of this insert in use.

Tray legend:

- Tray 1 - hunt tiles, and minion & shadow character figures
- Tray 2a, b - the north and elves figures
- Tray 3 - isengard figures
- Tray 4 - nazgul figures
- Tray 5a, b - gondor and rohan figures
- Tray 6a - dice and settlement control markers
- Tray 6b - other tokens
- Tray 7a, b - sauron and southron & easterling figures
- Tray 8a, b - dwarves and fellowship figures
- Tray 9a, b - free peoples and shadow factions figures
- Tray 10 - cards

Tip: Keep the instructions in the bottom of your board game box as a reminder of how the insert fits together.