

Assembly Instructions

FS-NMS

The package contains 9 sheets, four identical to the other four and one different sheet.

After assembly the trays are put in three layers in the original game box.

Ordinary PVA glue is required when assembling each tray.

Please make sure you dry-assemble each tray correctly before gluing it together.

Please check www.foldedspace.net for general assembly tips.

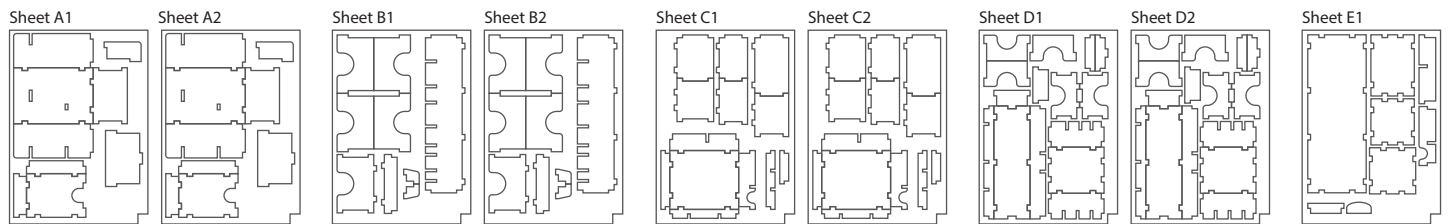
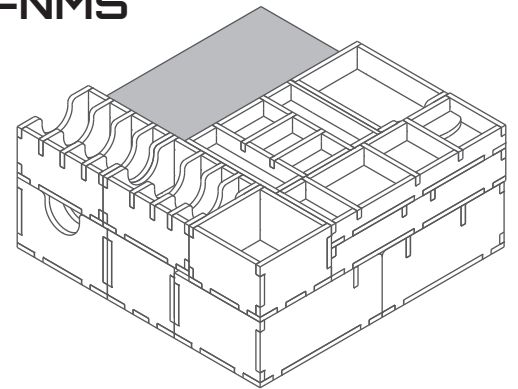

Tray 1a & 1b (the trays are identical)

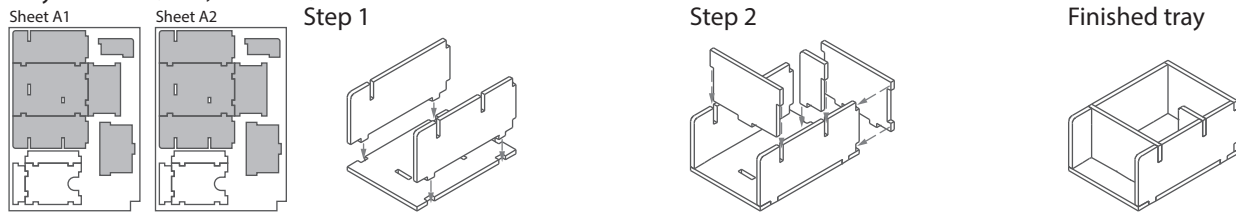

Tray 2a & 2b (the trays are identical)

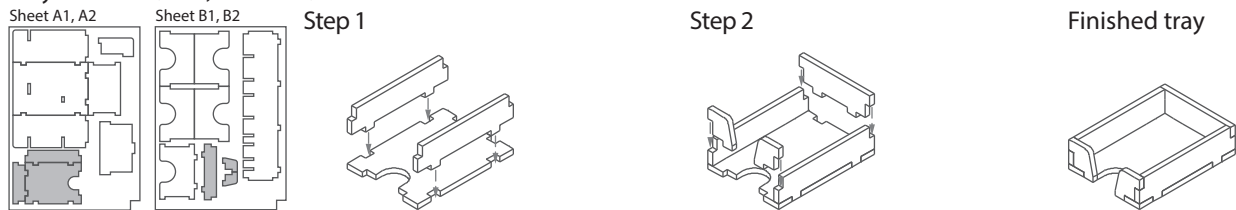

Tray 3a

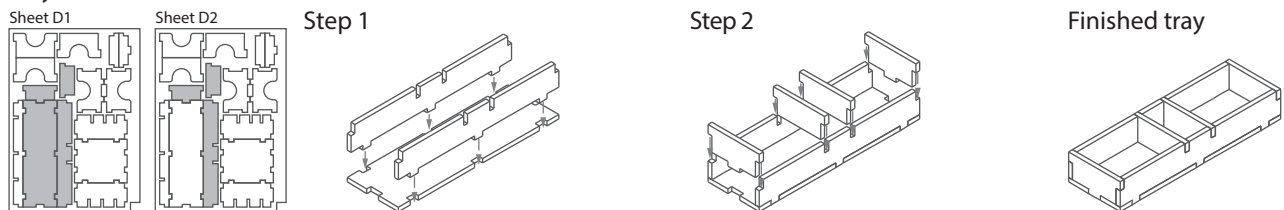

Tray 3b

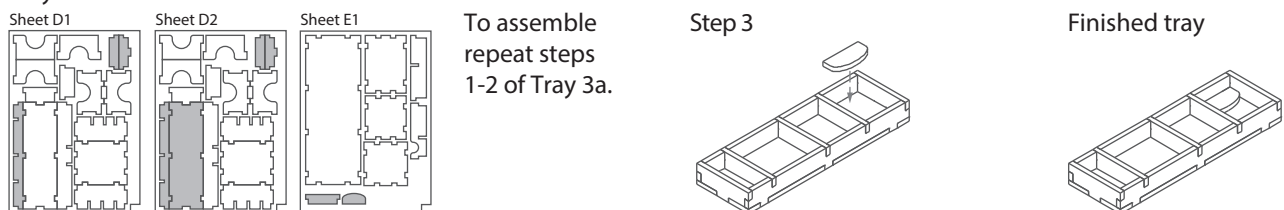

Tray 4a

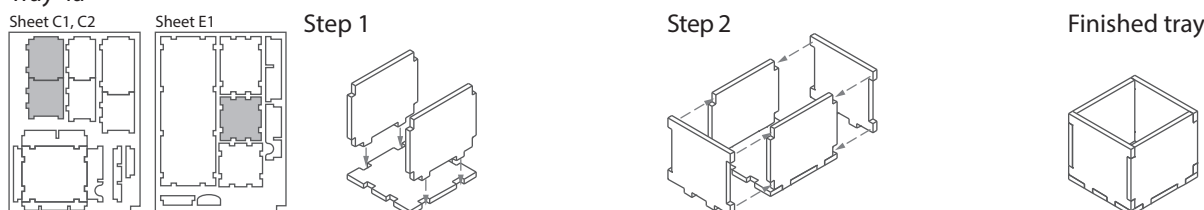

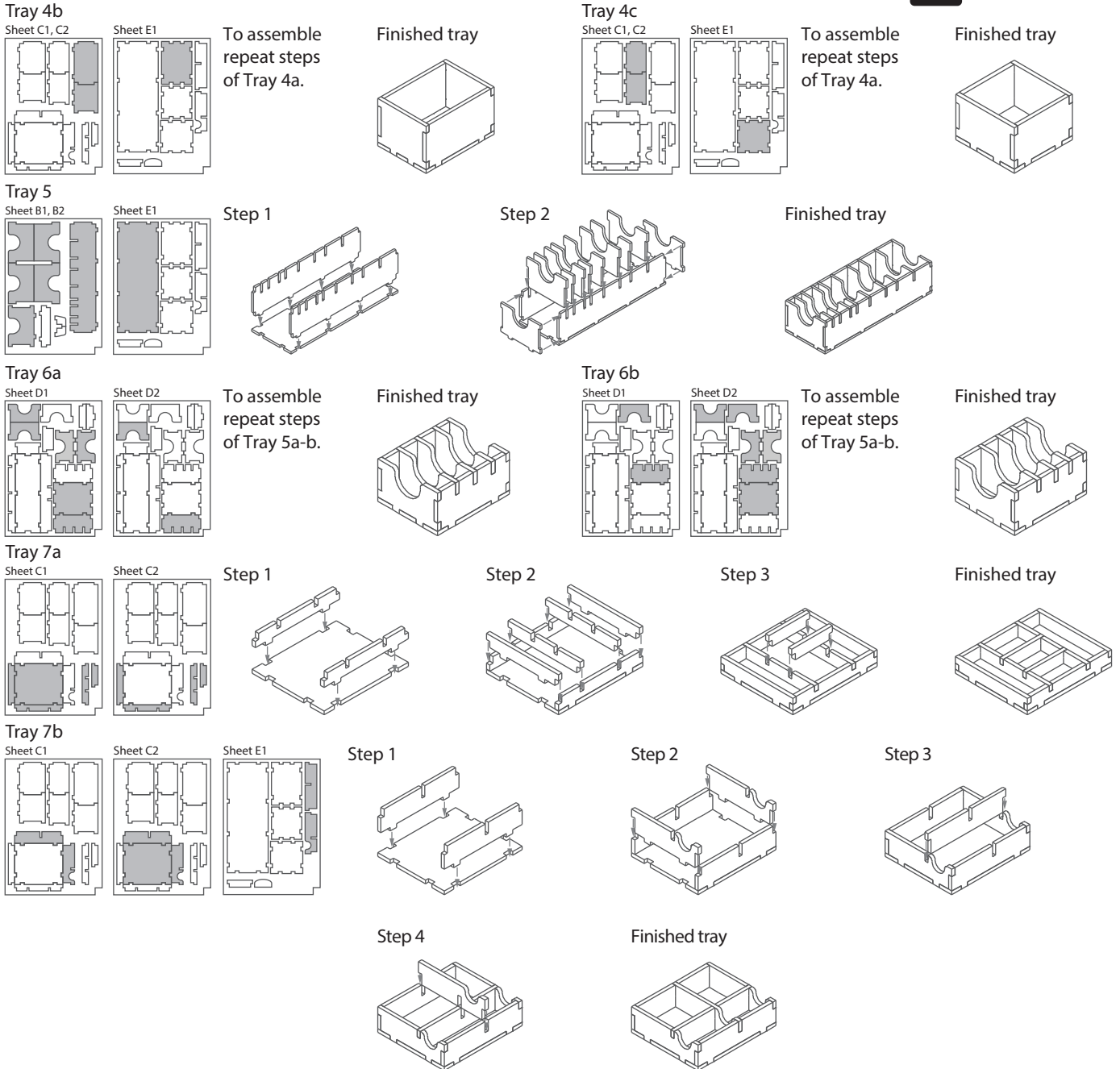

FS-NMS

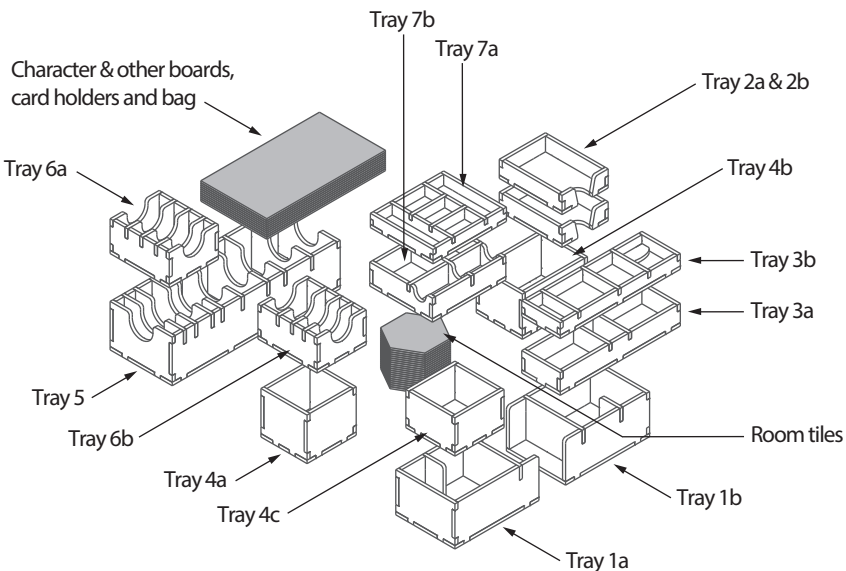

Please check www.foldedspace.net for photos of this insert in use.

Tray legend:

- Tray 1a, b - queen, breeders, creepers, and two low adult intruders
- Tray 2a - contamination cards
- Tray 2b - solo, promo, and intruder action cards
- Tray 3a - doors, dice, and large tokens
- Tray 3b - ammo, noise, status, and fire markers
- Tray 4a, b - four tall adult intruders
- Tray 4c - two low adult intruders
- Tray 5 - main large card tray
- Tray 6a - item cards
- Tray 6b - small character and other small cards
- Tray 7a - malfunction markers and exploration, intruder carcass, intruder egg & other tokens
- Tray 7b - larvae & character miniatures, and intruder token stack