

FS-DMN insert compatible with Dominion[®] including space for various expansions



Assembly Instructions

The package contains 4 sheets, two of them are identical to the other two.

The parts marked in sheet A2 are to be discarded.

After assembly the trays are put in up to three layers in the original game box.

Ordinary PVA glue is required when assembling each tray.

Please make sure you dry-assemble each tray correctly before gluing it together.

Please check www.foldedspace.net for general assembly tips.

The insert can store up to 1,150 sleeved or 1,850 unsleeved cards.

The insert can be used in one of two ways, Variant 1 for less tokens but more game mats, or Variant 2 for more tokens and less mats.

FS-DMN

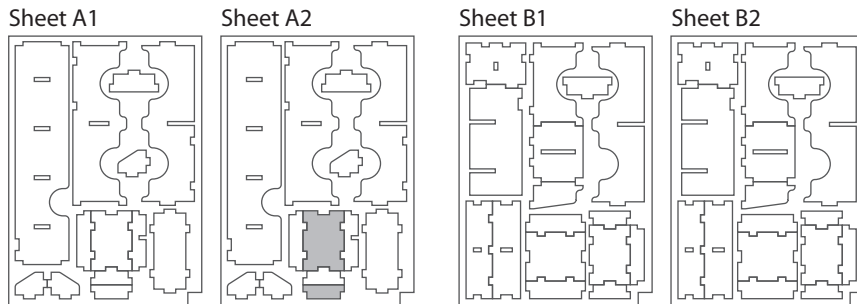
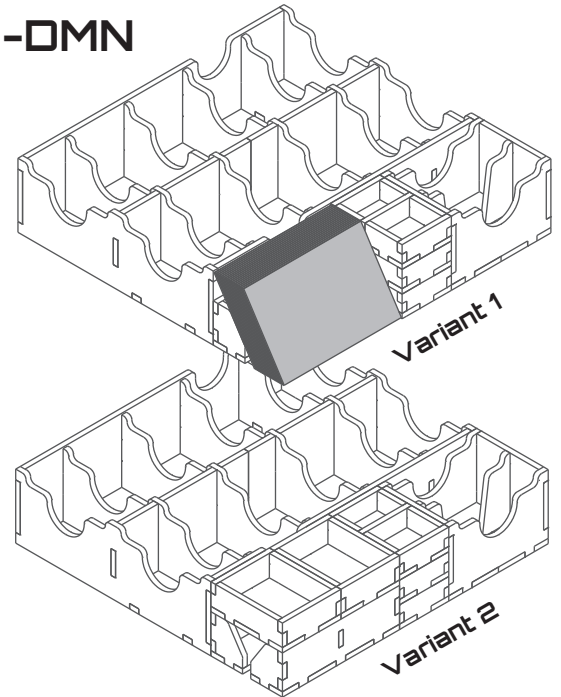

Tray 1a & 1b (the trays are identical)

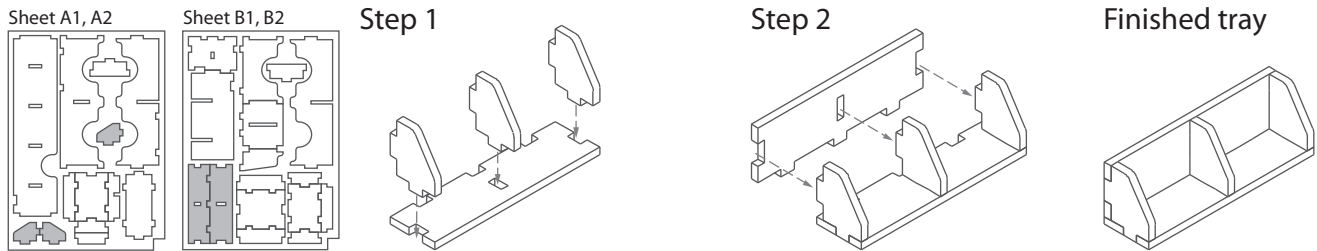

Tray 2a & 2b (the trays are identical)

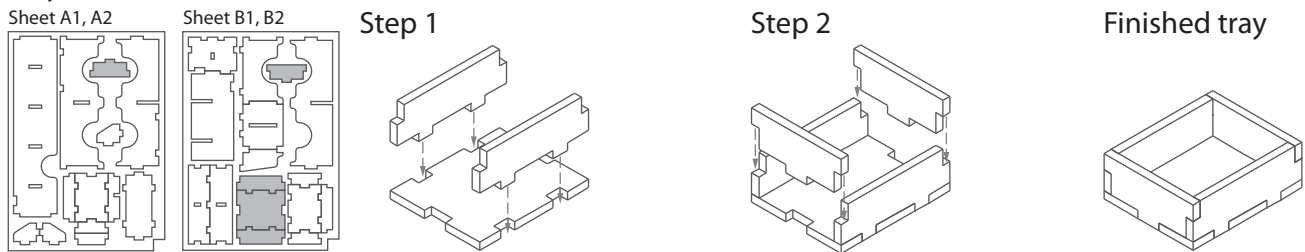

Tray 3

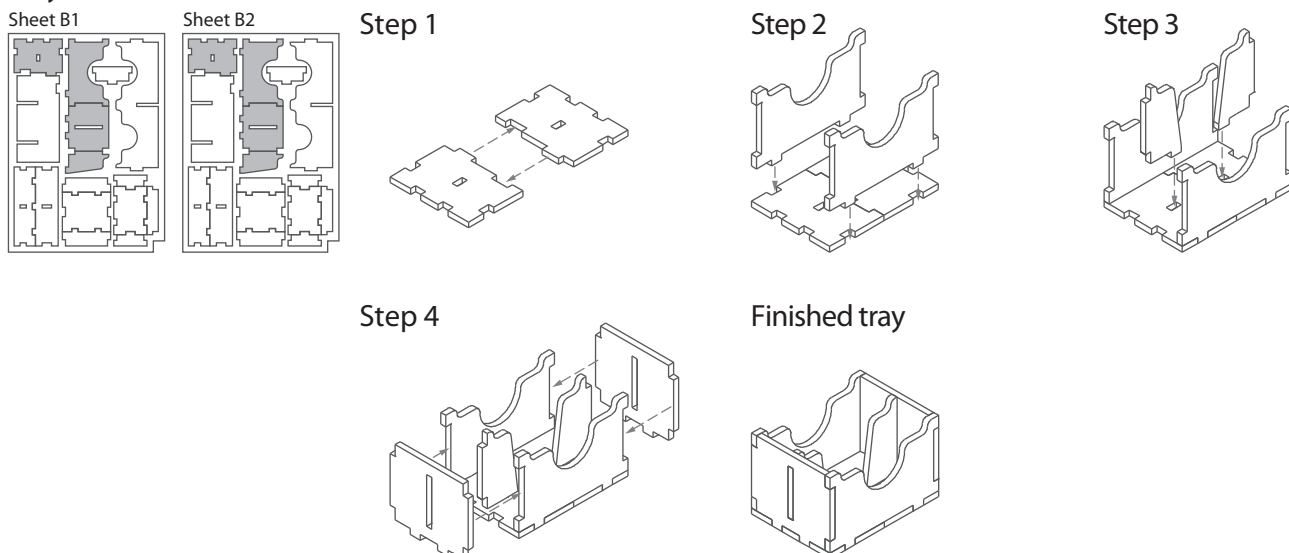

Tray 4

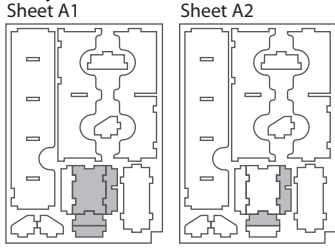

Step 1

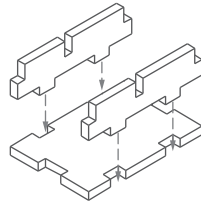

Step 2

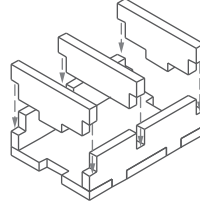

Finished tray

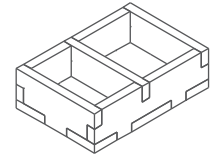

Tray 5a & 5b

(the trays are identical)

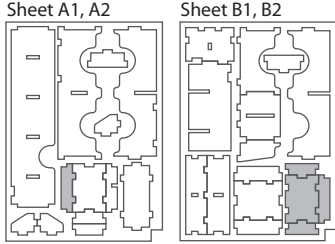

Step 1

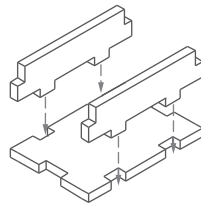

Step 2

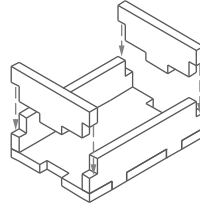

Finished tray

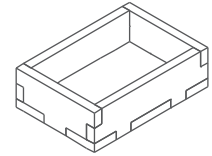

Tray 6

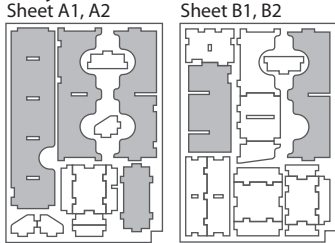

Step 1

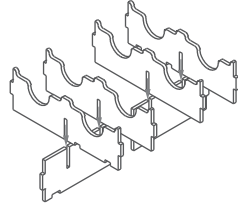

Step 2

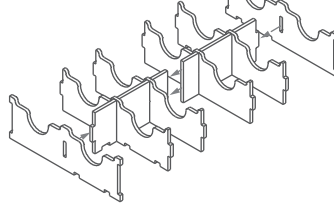

Step 3

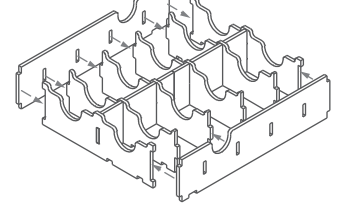

Step 4

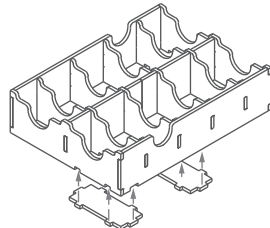

Finished tray

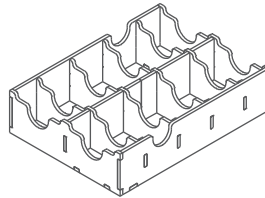

Please check www.foldedspace.net for photos of this insert in use.

FS-DMN

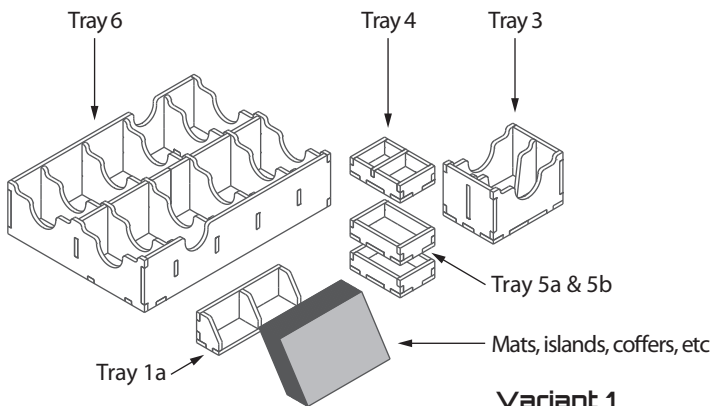

Variant 1

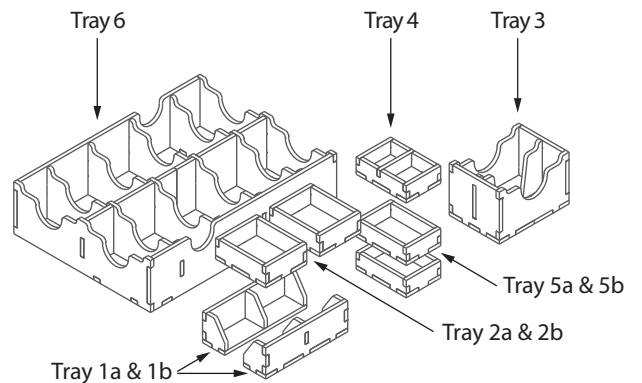

Variant 2

Tray legend:

- Tray 1a, b - filler trays, to position either mats or additional token trays depending on variant used
- Tray 2a, b - additional token trays for Variant 2
- Tray 3 - victory, curse, and randomizer cards
- Tray 4 - token trays
- Tray 5a, b - token trays

Tray 6 - main card tray, we recommend using the two corner slots which have bases for the treasure cards

Note: the mats, islands, coffer and other expansion large tiles can also be placed on top of the cards in Tray 6 in the recess provided for this.

Tip: Keep the instructions in the bottom of your board game box as a reminder of how the insert fits together.