

Assembly Instructions

The package contains 5 sheets, two identical to the other two and one different sheet.

After assembly the trays are put in four layers in the original game box.

Ordinary PVA glue is required when assembling each tray.

Please make sure you dry-assemble each tray correctly before gluing it together.

Please check www.foldedspace.net for general assembly tips.

FS-HLRT

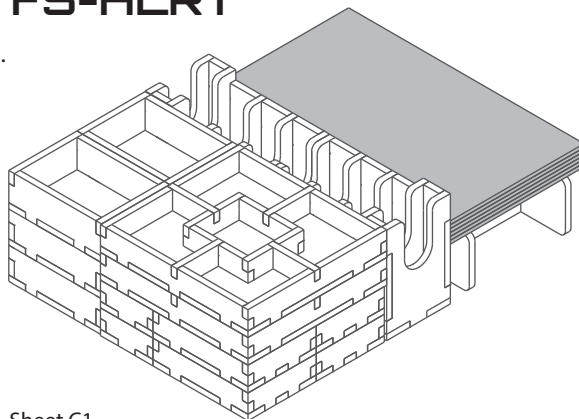

Sheet A1

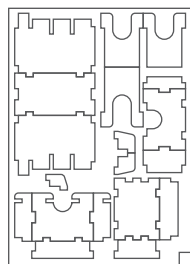

Sheet A2

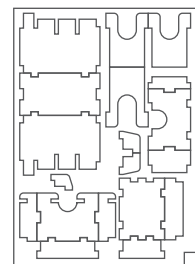

Sheet B1

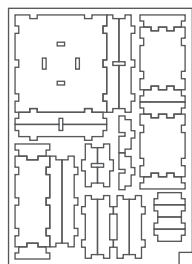

Sheet B2

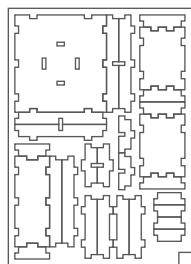

Sheet C1

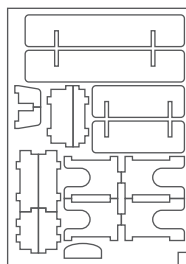

Tray 1a & 1b

(the trays are identical)

Sheet A1, A2

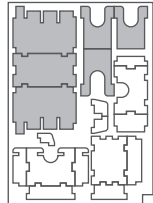

Sheet C1

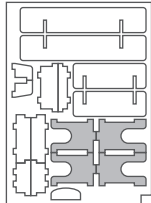

Step 1

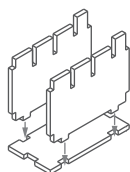

Step 2

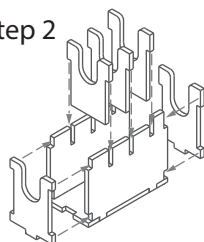

Finished tray

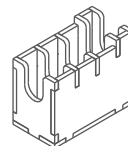

Tray 2a

Sheet A1

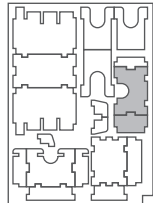

Sheet A2

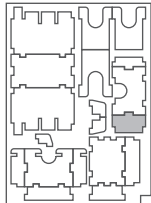

Sheet C1

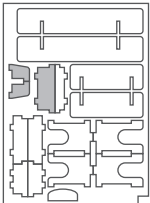

Step 1

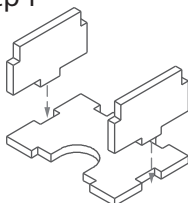

Step 2

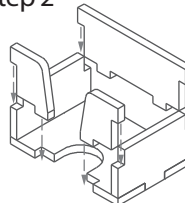

Finished tray

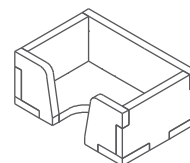

Tray 2b

Sheet A1

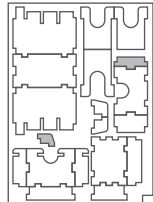

Sheet A2

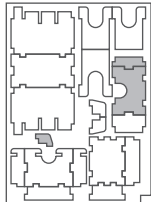

Sheet C1

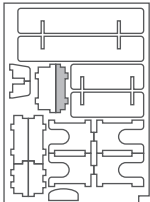

Step 1

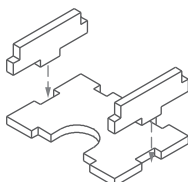

Step 2

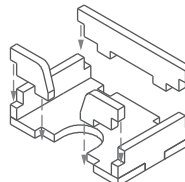

Finished tray

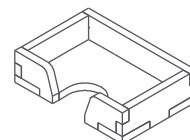

Tray 3

Sheet C1

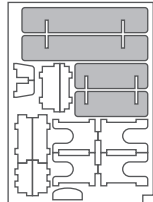

Step 1

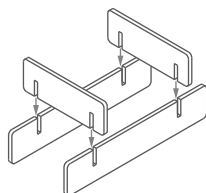

Finished tray

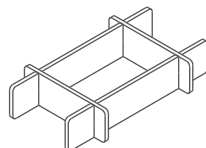

Tray 4a

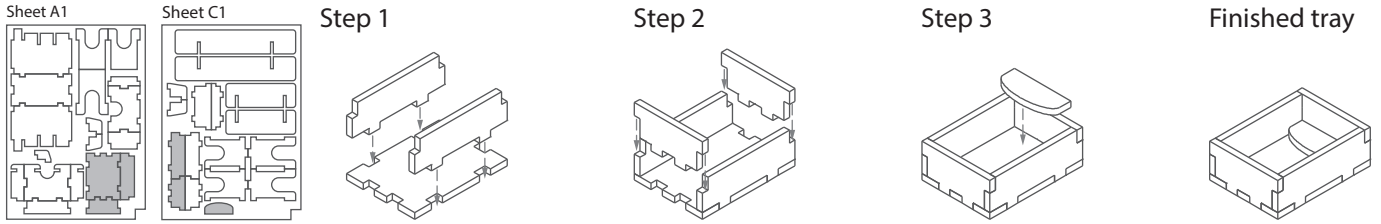

Tray 4b

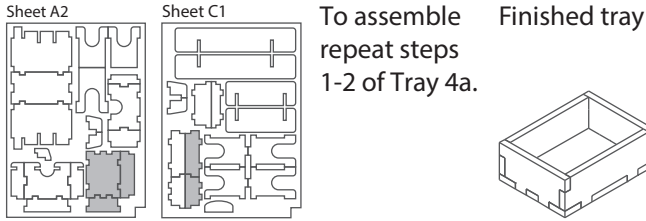

Tray 5a, 5b, 5c & 5d (the trays are identical)

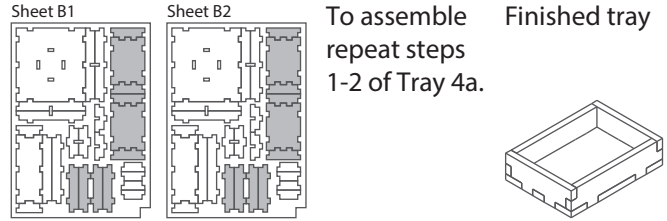

Tray 6a & 6b

(the trays are identical)

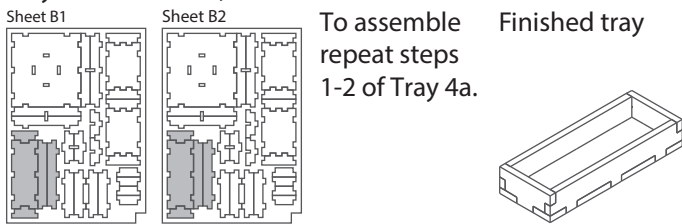

Tray 7a & 7b

(the trays are identical)

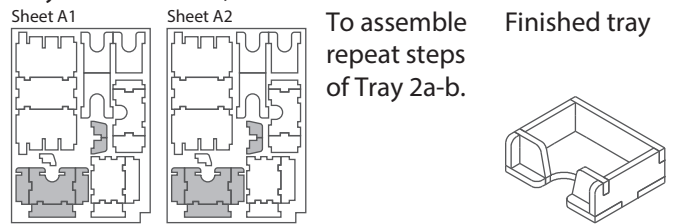

Tray 8a & 8b

(the trays are identical)

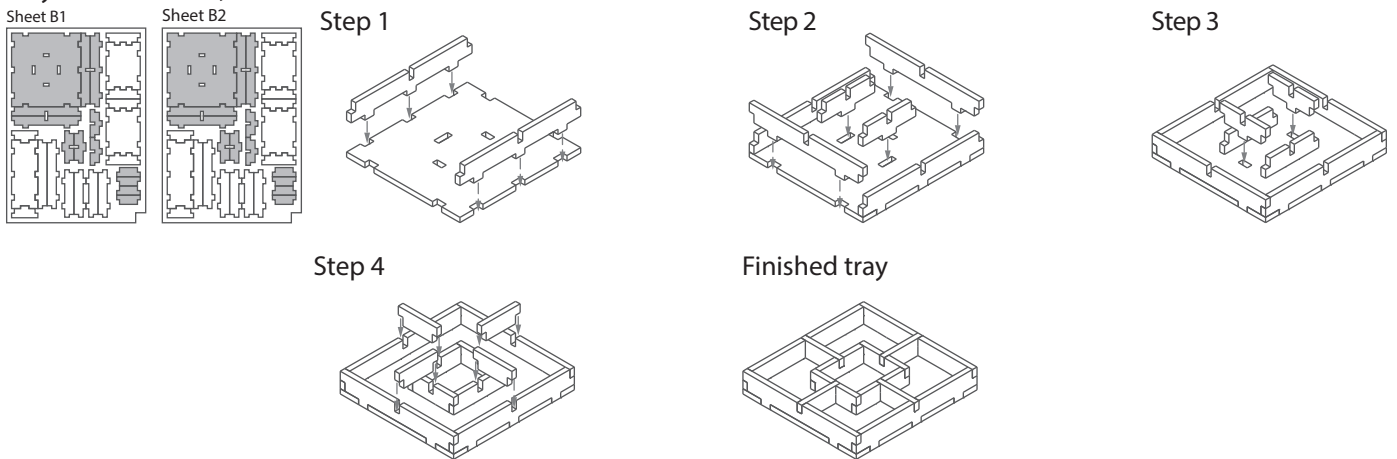

FS-HLRT

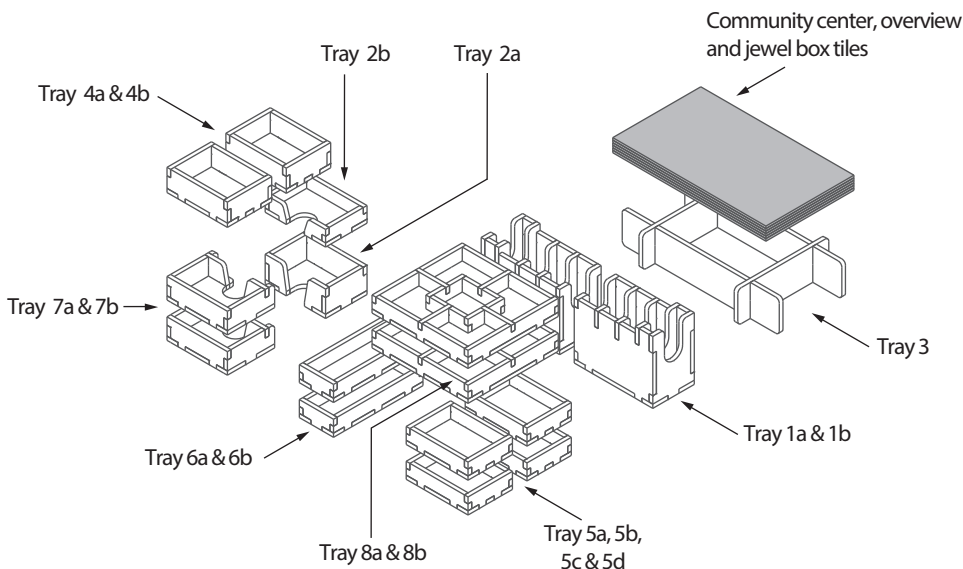

Please check www.foldedspace.net for photos of this insert in use.

Tray legend:

- Tray 1a - quadrant cards and three farmyard decks
- Tray 1b - three gateway decks
- Tray 2a - bonus cards
- Tray 2b - point cards
- Tray 4a - worker cubes
- Tray 4b - sheep
- Tray 5a, b, c, d - player pieces, each including six worker cubes
- Tray 6a, b - field and tool tokens
- Tray 7a, b - gateway and farmyard decks currently used for game play
- Tray 8a - hides, wool, flax, milk and first player tokens
- Tray 8b - barley, rye, meat, hops and clay