

# FS-ISLAv2 insert

compatible with Spirit Island<sup>®</sup>,

incl. the Branch and Claw<sup>®</sup> expansion,

or separately with the Jagged Earth<sup>®</sup> expansion and Promos 1 & 2



## Assembly Instructions

The package contains 4 sheets, two of them are identical to the other two.

The part marked in sheet A2 is to be discarded.

After assembly the trays are put in two layers in the original game box.

Ordinary PVA glue is required when assembling each tray.

Please make sure you dry-assemble each tray correctly before gluing it together.

Please check [www.foldedspace.net](http://www.foldedspace.net) for general assembly tips.

Jagged Earth has less boards, so some trays' height is raised as shown in the v2 tray versions.

### FS-ISLAv2

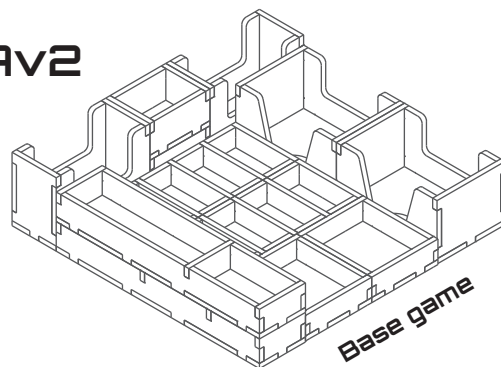

Base game

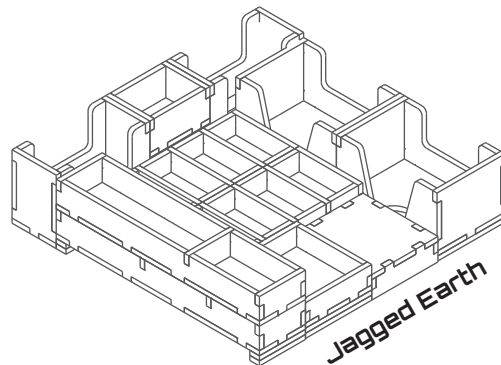

Jagged Earth

Sheet A1

Sheet A2

Sheet B1

Sheet B2

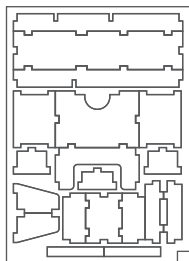
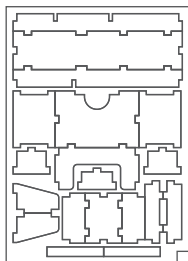
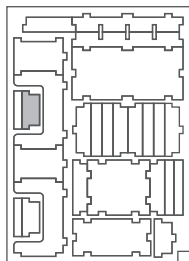
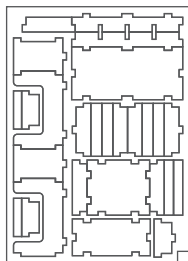

#### Tray 1a<sub>v1</sub> & 1b<sub>v1</sub> (v1 trays are used only in Base game version)

Sheet A1

Sheet A2

Step 1

Step 2

Finished tray

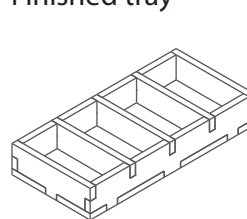
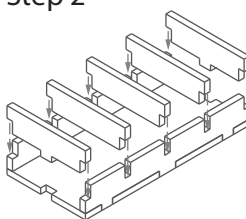
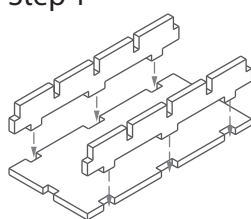
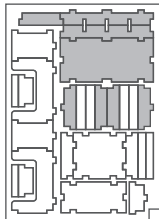
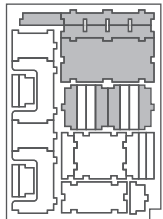

#### Tray 2a & 2b (the trays are identical)

Sheet A1

Sheet A2

Step 1

Step 2

Finished tray

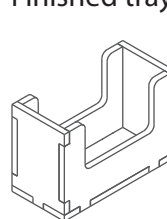
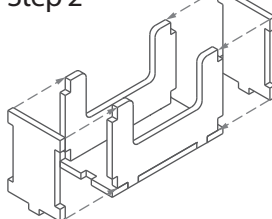
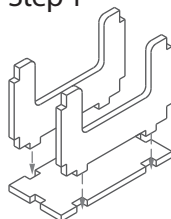
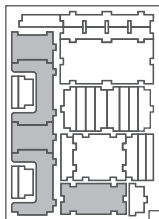
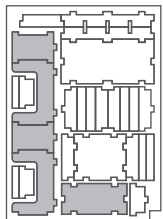

#### Tray 3a & 3b<sub>v1</sub> (v1 trays are used only in Base game version)

Sheet A1, A2

Sheet B1, B2

Step 1

Step 2

Finished tray

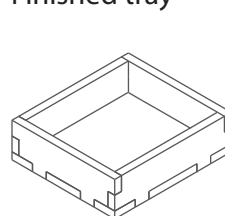
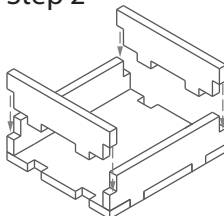
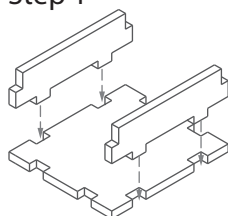
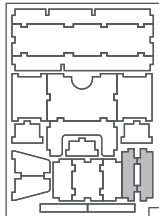
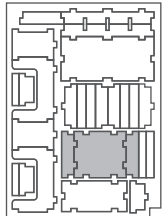

#### Tray 4a & 4b (the trays are identical)

Sheet B1

Sheet B2

Step 1

Step 2

Finished tray

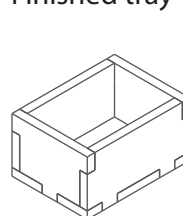
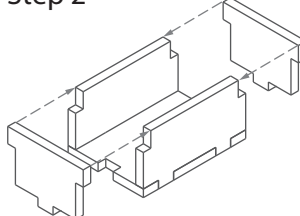
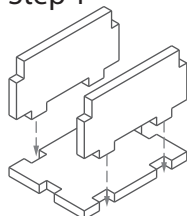
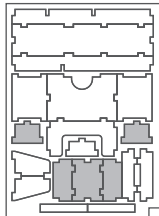
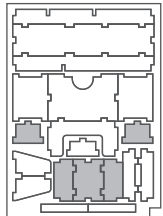

# FS-ISLAv2 insert compatible with Spirit Island® ,

incl. the Branch and Claw® expansion, or separately with the Jagged Earth® expansion and Promos 1 & 2



## Tray 5av1 & 5bv1 (v1 trays are used only in Base game version)

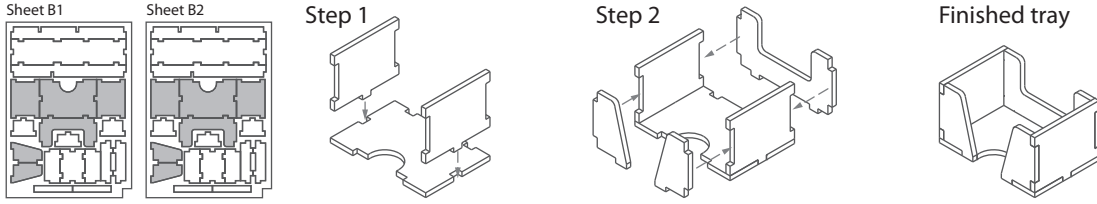

## Tray 6av1 (v1 trays are used only in Base game version)

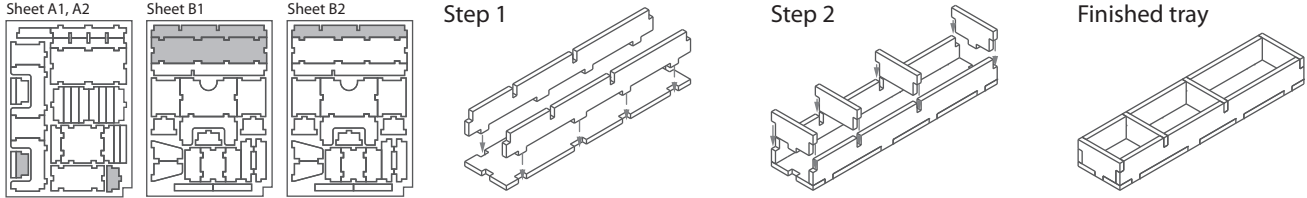

## Tray 6b

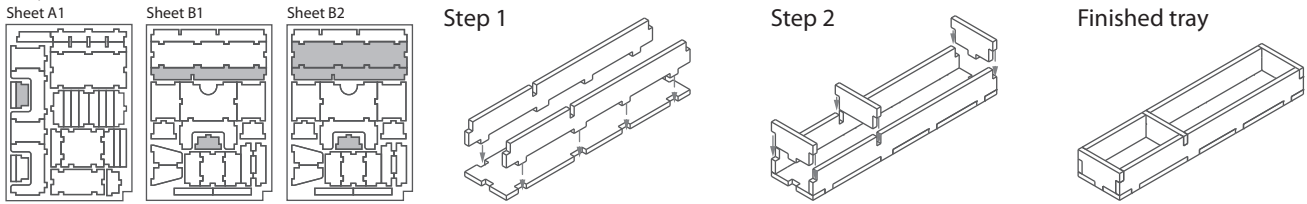

Following trays are made by attaching extra legs to v1 trays:

## Tray 1av2 & 1bv2 (v2 trays are used only in Jagged Earth game version)

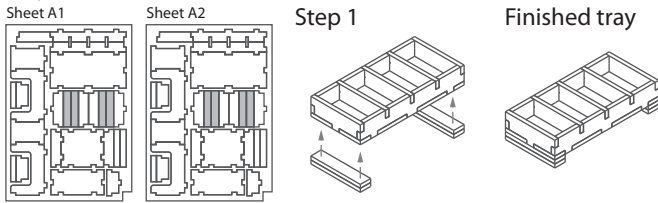

## Tray 3bv2 (v2 trays are used only in Jagged Earth game version)

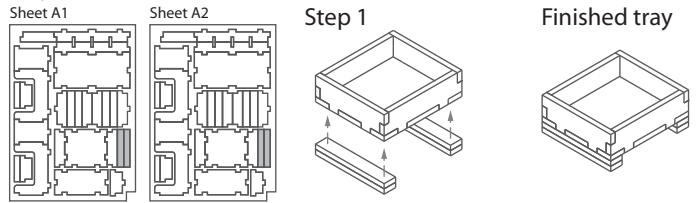

## Tray 5av2 & 5bv2 (v2 trays are used only in Jagged Earth game version)

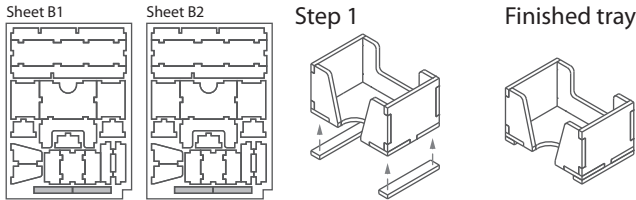

## Tray 6av2 (v2 trays are used only in Jagged Earth game version)

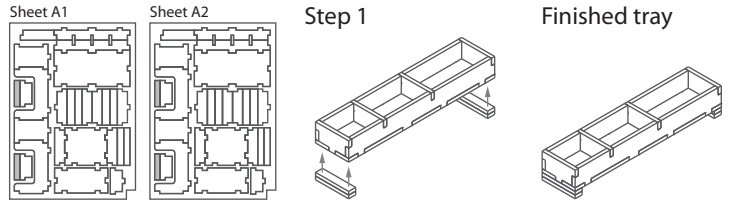

# FS-ISLAv2

Please check [www.foldedspace.net](http://www.foldedspace.net) for photos of this insert in use.

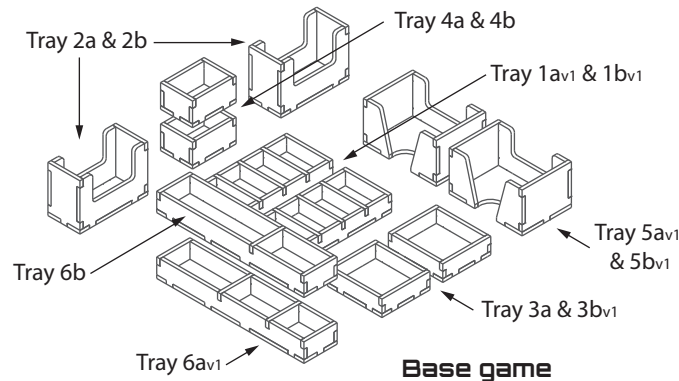

**Base game**

### Tray legend:

- Tray 1av1 - player pieces
- Tray 1bv1 - beasts, wilds, disease, strife tokens
- Tray 2a - unique power cards
- Tray 2b - other cards
- Tray 3a - explorers
- Tray 3bv1 - invader cards & small adversary tiles
- Tray 4a - energy markers
- Tray 4b - scenario markers
- Tray 5av1 - event cards
- Tray 5bv1 - power cards
- Tray 6av1 - blight, fear, dahan
- Tray 6b - cities, towns

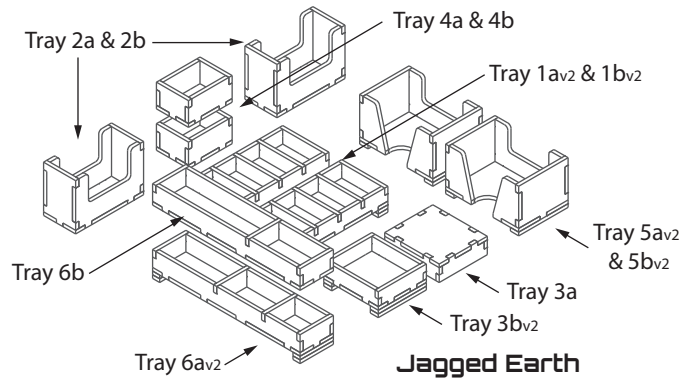

**Jagged Earth**

### Tray legend:

- Tray 1av2 - player pieces, badlands, & sml adversary tiles
- Tray 1bv2 - beasts, wilds, disease, strife tokens
- Tray 2a - unique power cards
- Tray 2b - other cards
- Tray 3a - not needed, add upside-down
- Tray 3bv2 - element markers
- Tray 4a - energy markers
- Tray 4b - scenario markers
- Tray 5av2 - event cards
- Tray 5bv2 - power cards
- Tray 6av2 - blight, fear, dahan
- Tray 6b - cities, towns
- Note: add explorers, other player pieces, reminder cards to the base game box.

**Tip:** Keep the instructions in the bottom of your board game box as a reminder of how the insert fits together.