

FS-WING insert compatible with Wingspan[®], incl. the European Expansion[®]



Assembly Instructions

FS-WING

The package contains 4 sheets, two of them are identical to the other two.

The parts marked in sheet B2 are to be discarded.

After assembly the trays are put in three layers in the original game box.

Ordinary PVA glue is required when assembling each tray.

Please make sure you dry-assemble each tray correctly before gluing it together.

Please check www.foldedspace.net for general assembly tips.

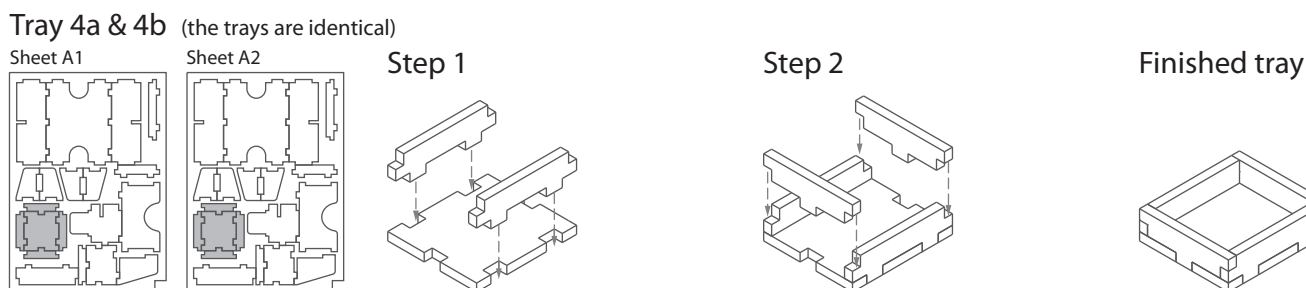
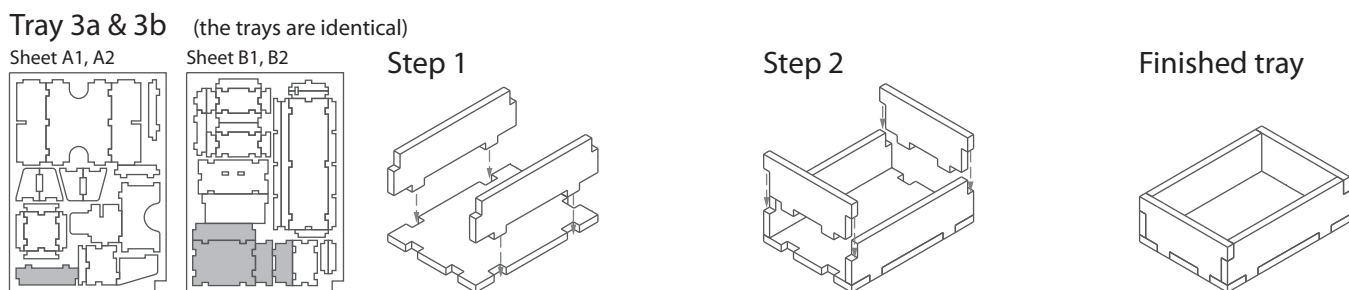
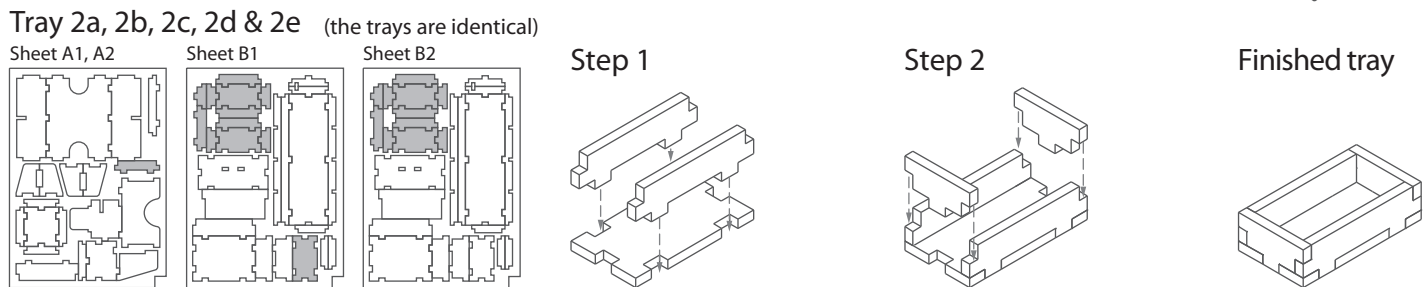
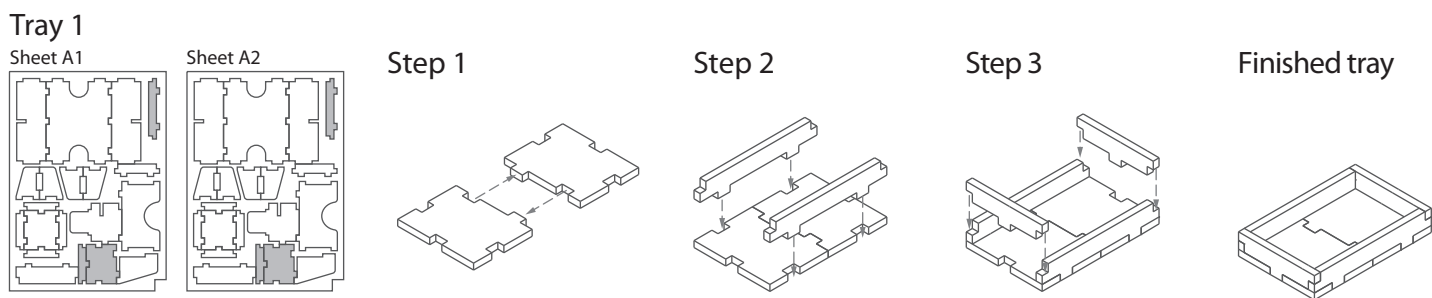
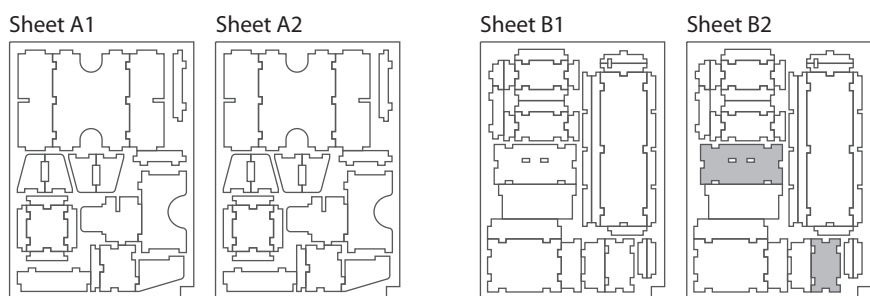
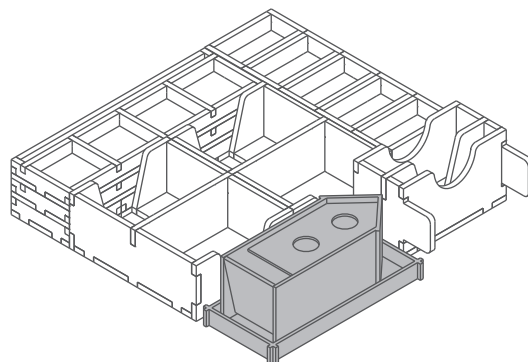

Tray 5a & 5b

Sheet A1, A2

Sheet B1, B2

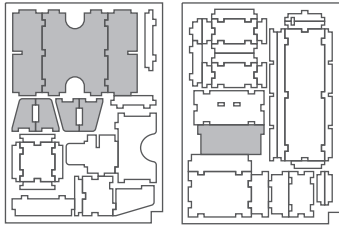

Step 1

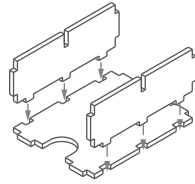

Step 2

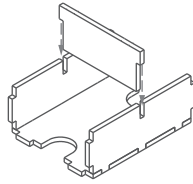

Step 3

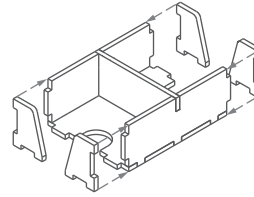

Finished tray

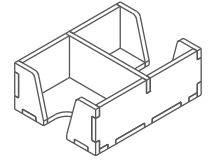

Tray 6

Sheet A1, A2

Sheet B1

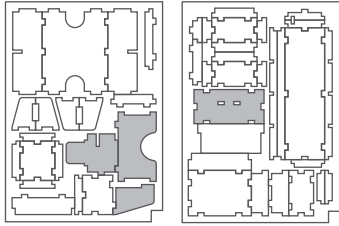

Step 1

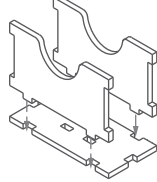

Step 2

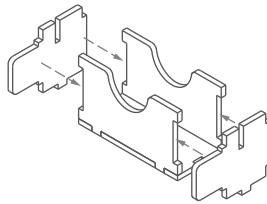

Step 3

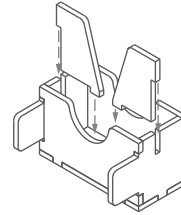

Finished tray

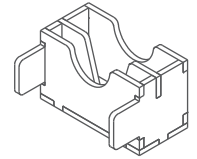

Tray 7a & 7b

Sheet B1

Sheet B2

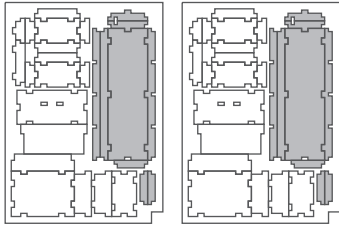

Step 1

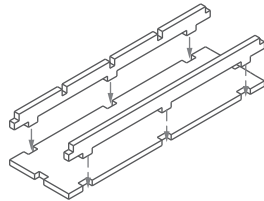

Step 2

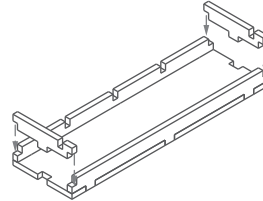

Step 3

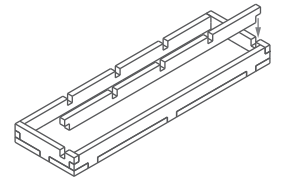

Tray 4

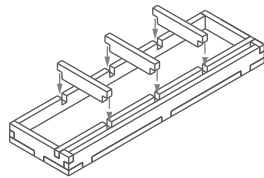

Finished tray

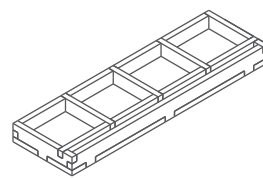

FS-WING

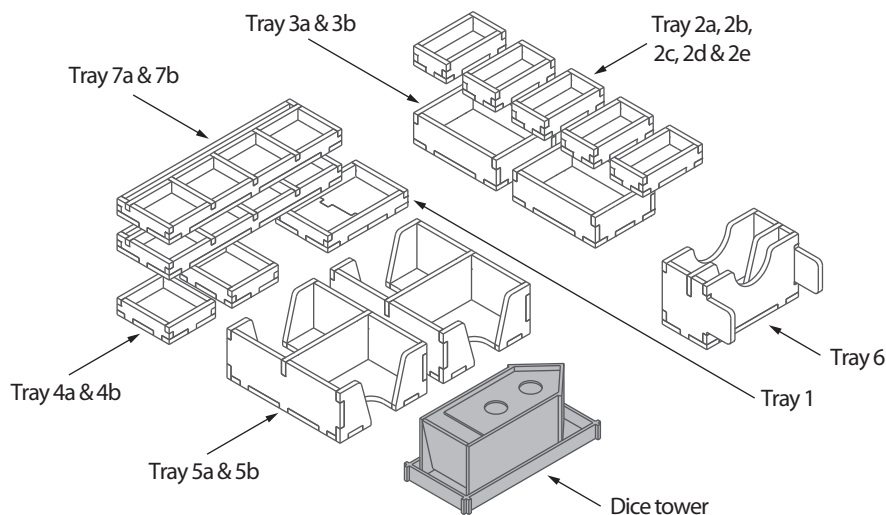

Please check www.foldedspace.net for photos of this insert in use.

Tray legend:

- Tray 1 - goal tiles
- Tray 2a, b, c, d, e - player pieces, including starting food tokens
- Tray 3a, b - egg miniatures
- Tray 4a, b - rodent food tokens
- Tray 5a, b - bird cards
- Tray 6 - bonus and automa cards
- Tray 7a, b - remaining food tokens

Note: the wooden dice are placed in the dice tower. Also note that during game play the slot down one side of Tray 7 can be used to hold the three face-up bird cards so all players can see them. There is no space in the insert for the two large plastic trays for cards, though these can be stored separately in the expansion box.