

FS-MAN insert compatible with Mansions of Madness 2nd Edition[®], **Folded Space**

incl. Beyond the Threshold[®], Streets of Arkham[®], Sanctum of Twilight[®] and Horrific Journeys[®] expansions.

Assembly Instructions

The package contains 8 sheets, four of them are identical to the other four.

The parts marked in sheets A2, B2, C2, D1, D2 are to be discarded.

After assembly the trays are put in two layers in the original game box.

Ordinary PVA glue is required when assembling each tray.

Please make sure you dry-assemble each tray correctly before gluing it together.

Please check www.foldedspace.net for general assembly tips and images of insert in use.

FS-MAN

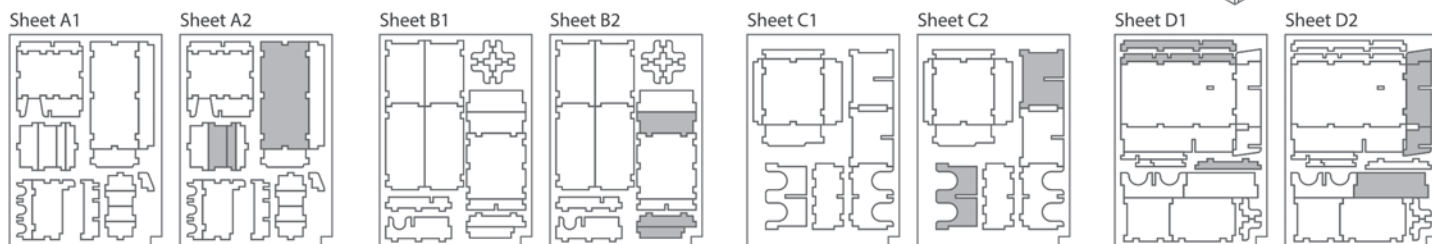
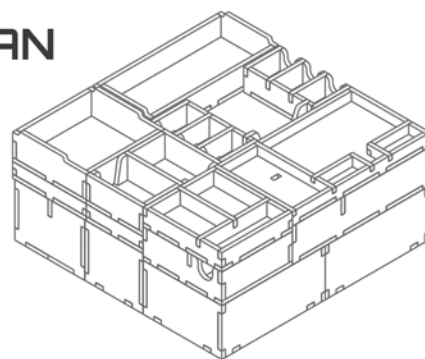

Tray 1a

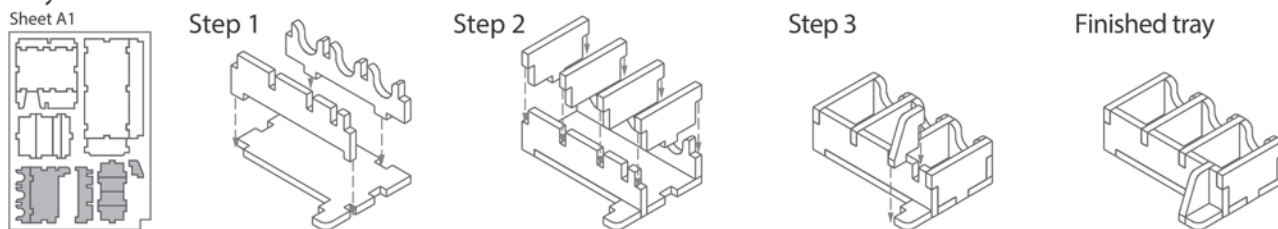

Tray 1b (the tray is mirrored version of Tray 1a)

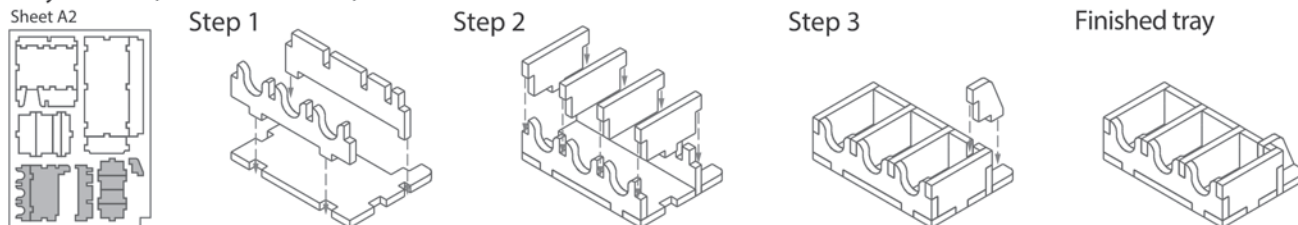

Tray 2

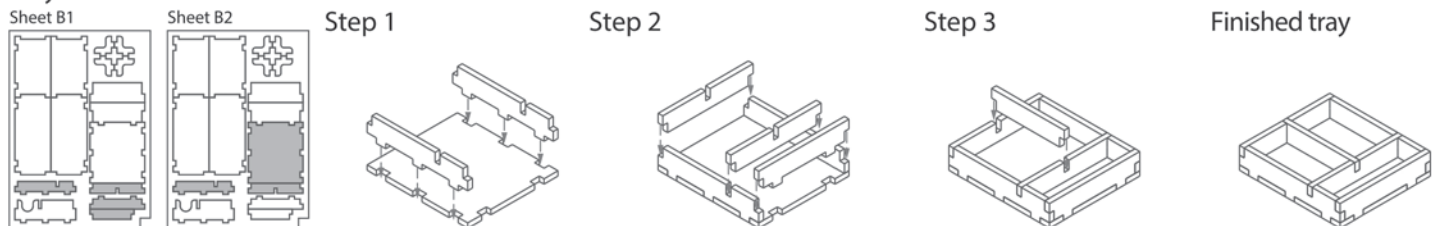

Tray 3

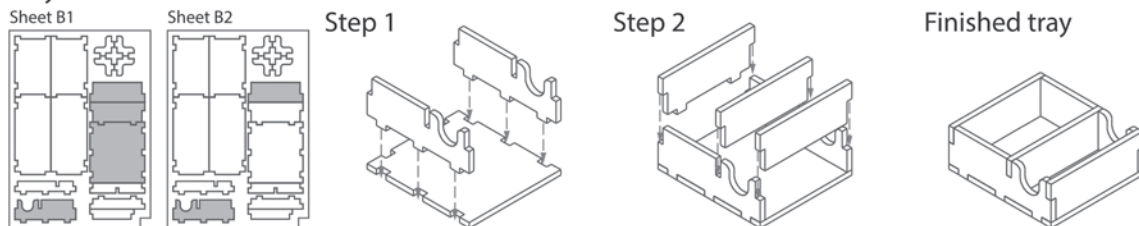

Tray 4

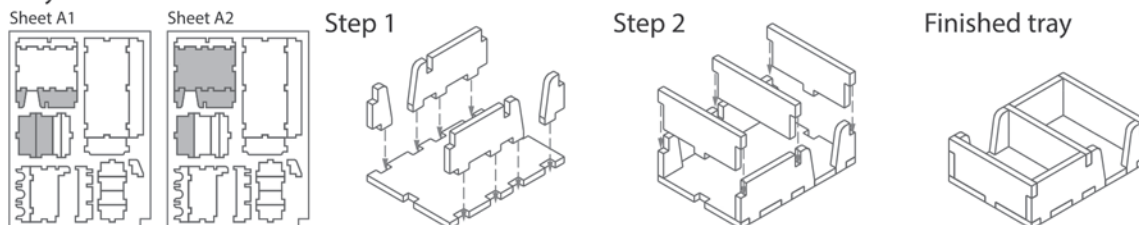

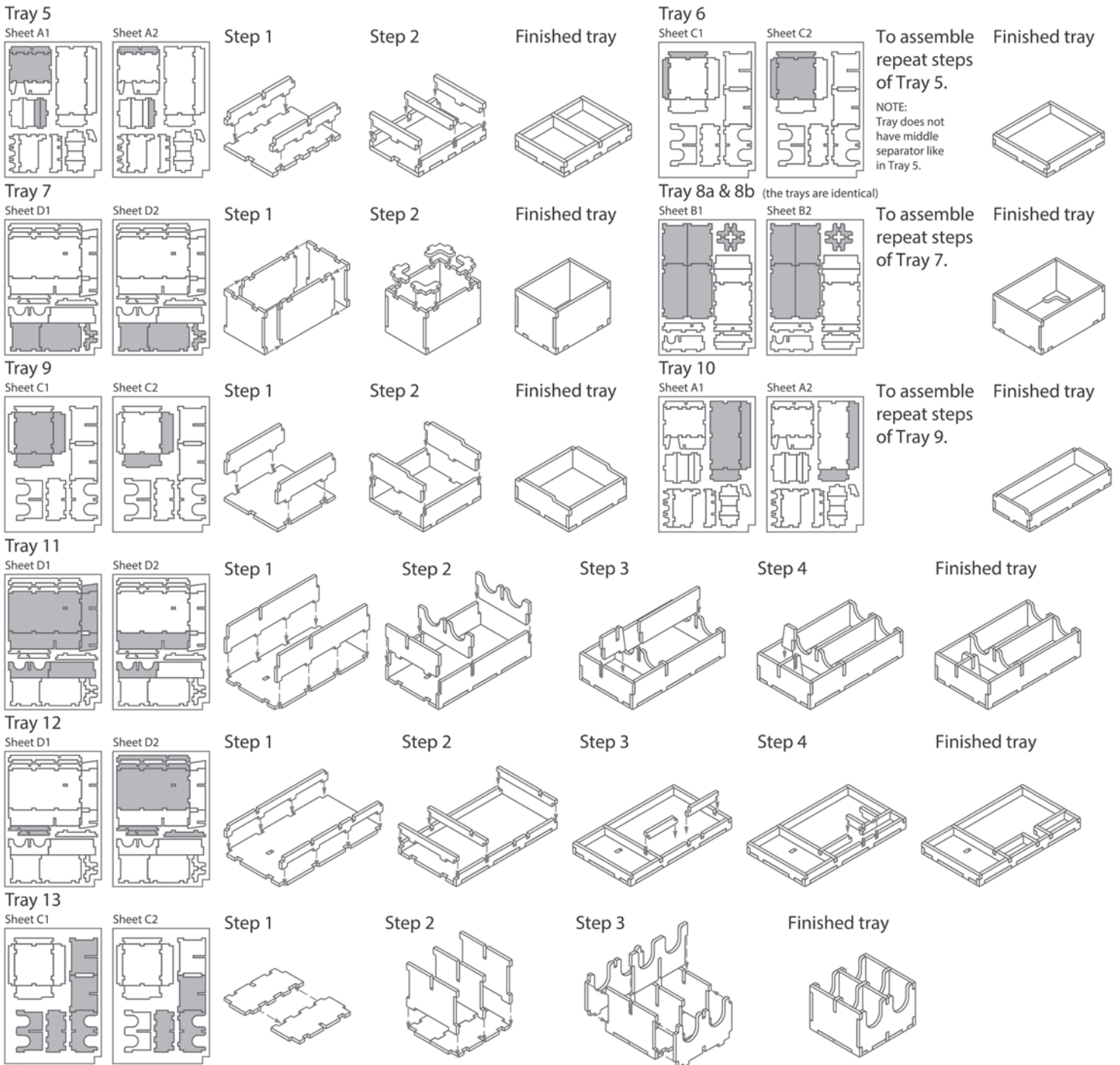

FS-MAN

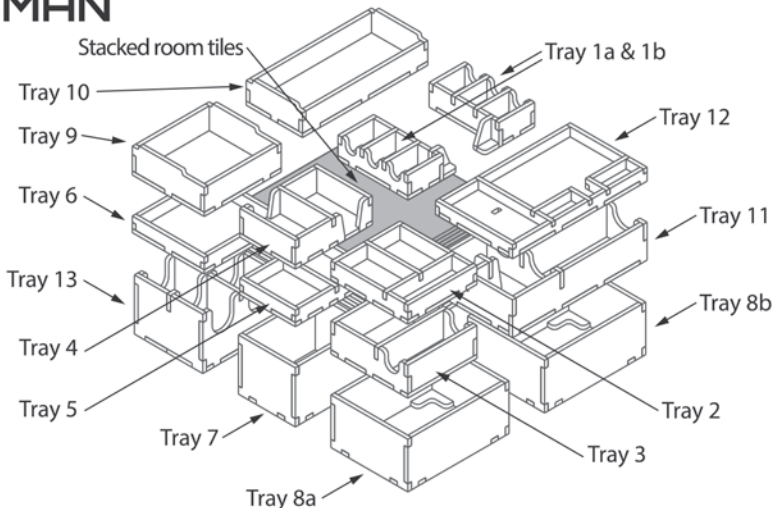

Note: all small and square room tiles need to be stacked in a square column in the top corner.

Tray legend:

- Tray 1a, b - fire, drift & barricade/passage tokens
- Tray 2 - action tokens & dice
- Tray 3 - clue tokens & small/med. monster tiles
- Tray 4 - damage & horror cards
- Tray 5 - improvement & restraint tokens
- Tray 6 - person tokens
- Tray 7 - medium monster figures
- Tray 8a, b - large monster figures
- Tray 9 - investigator figures
- Tray 10 - small monster figures
- Tray 11 - large/med. monster tiles & small/med. monster bases
- Tray 12 - investigator cards, wall/door tokens, & ID tokens
- Tray 13 - all other cards