

Assembly Instructions

The package contains 9 sheets.

After assembly the trays are put in layers in the original game box.

Ordinary PVA glue is required when assembling each tray, for extra strength.

Please make sure you dry-assemble each tray correctly before gluing it together.

Please check www.foldedspace.net for general assembly tips.

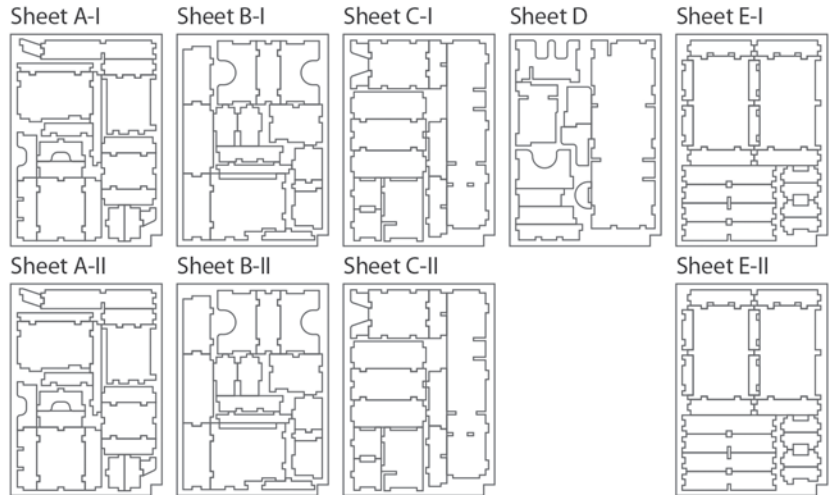

Tray 1a & 1b (the trays are identical)

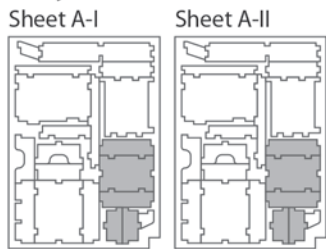

Step 1

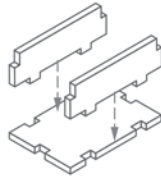

Step 2

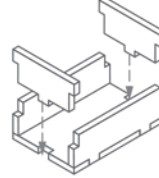

Finished tray

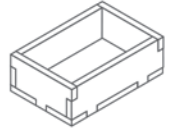

Tray 2

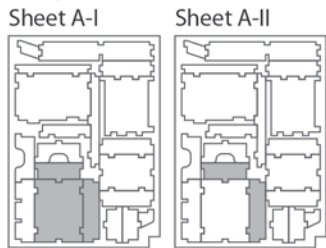

Step 1

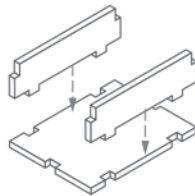

Step 2

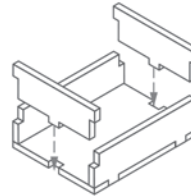

Finished tray

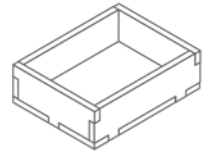

Tray 3

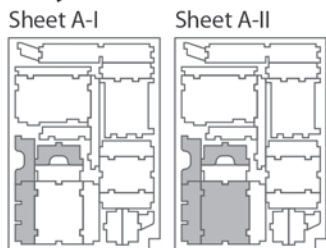

Step 1

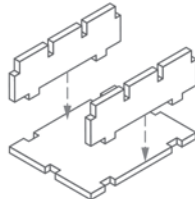

Step 2

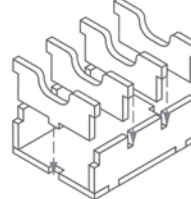

Finished tray

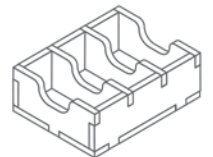

Tray 4

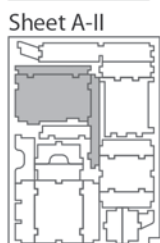
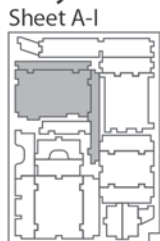

Step 1

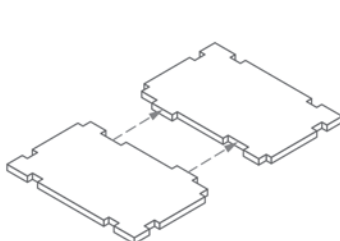

Step 2

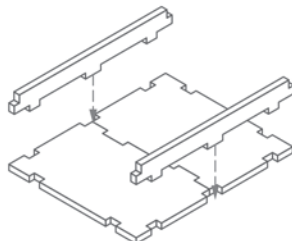

Step 3

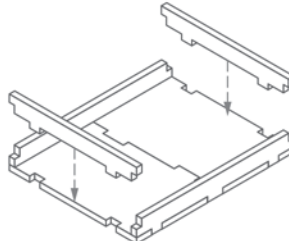

Finished tray

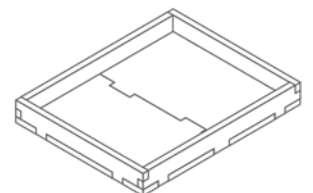

Tray 5

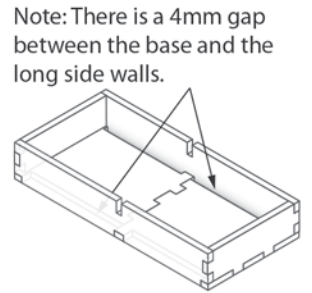
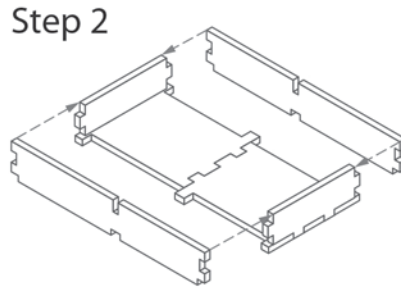
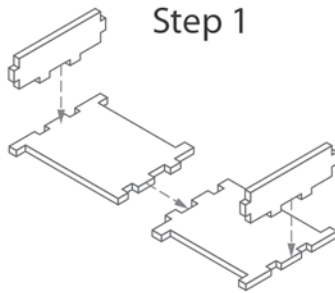
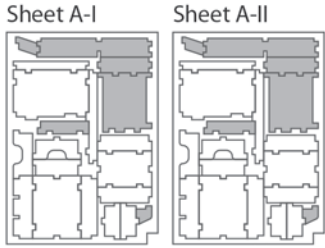

Step 3

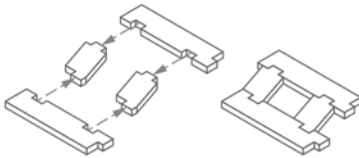

Step 4 - Align as shown and glue to base.

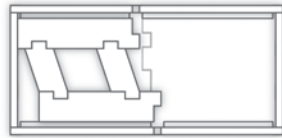

Step 5

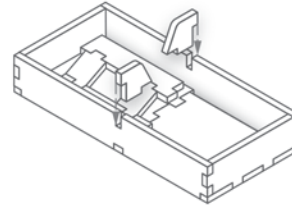

Finished tray

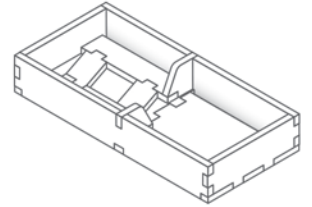

Tray 6a & 6b (the trays are identical)

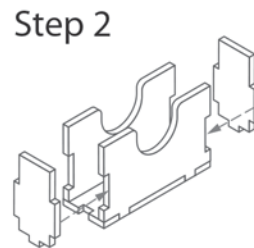
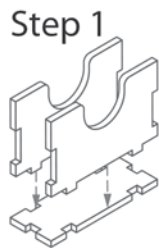
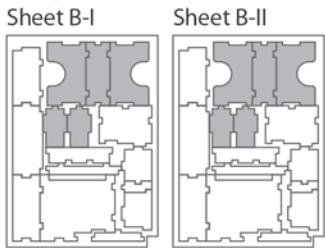

Finished tray

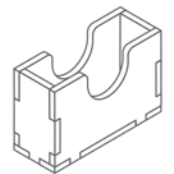

Tray 7

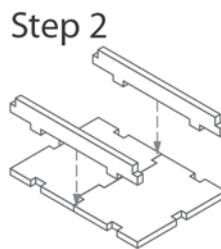
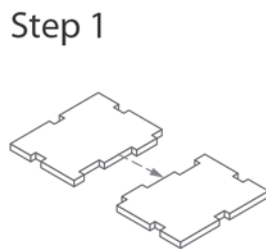
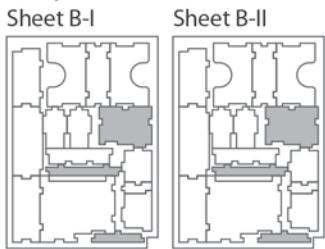

Finished tray

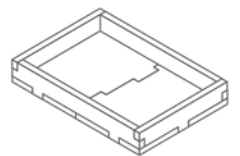

Tray 8a & 8b (the trays are identical)

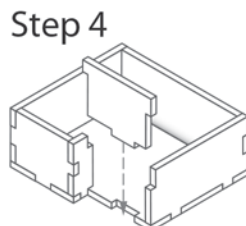
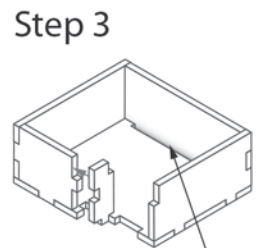
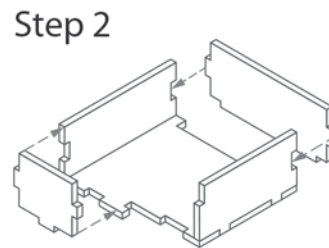
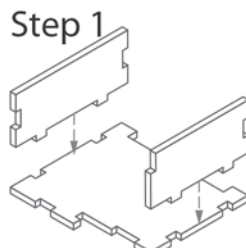
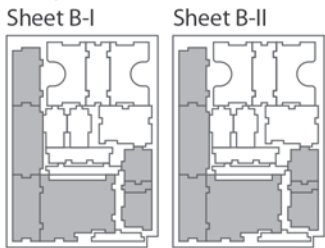

Finished tray

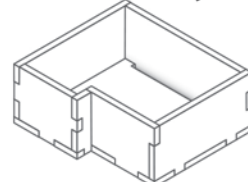

Note: There is a 4mm gap between the base and the rear wall.

Tray 9a & 9b (the trays are identical)

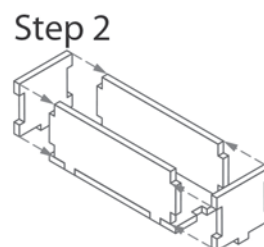
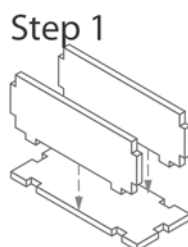
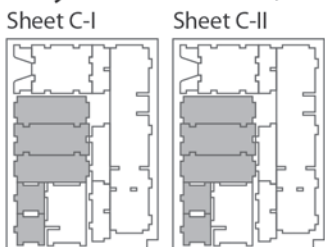

Finished tray

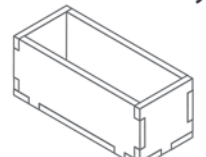

Tray 10

Sheet C-I

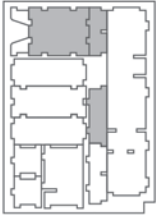

Sheet C-II

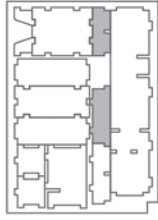

Sheet D

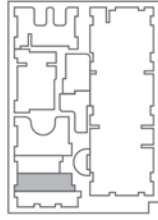

Step 1

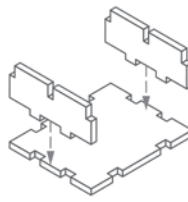

Step 2

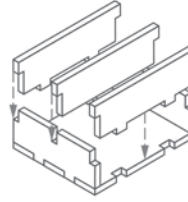

Finished tray

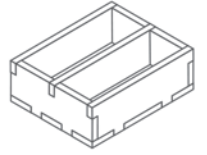

Tray 11

Sheet C-I

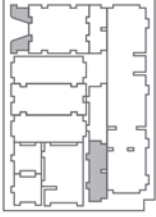

Sheet C-II

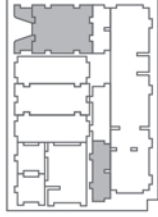

Sheet D

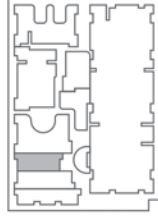

Step 1

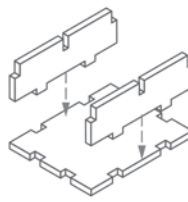

Step 2

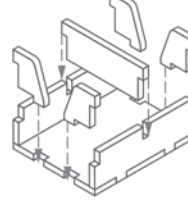

Finished tray

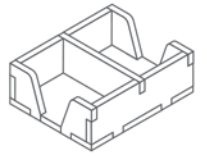

Tray 12

Sheet C-I

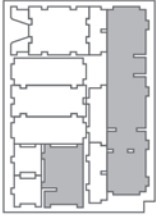

Sheet C-II

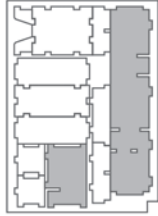

Sheet D

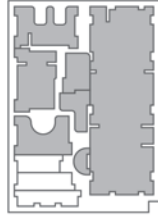

Step 1

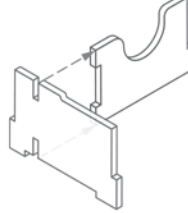

Step 2

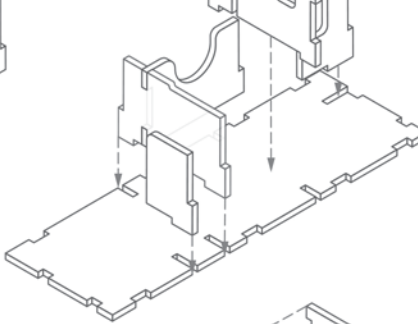

Step 3

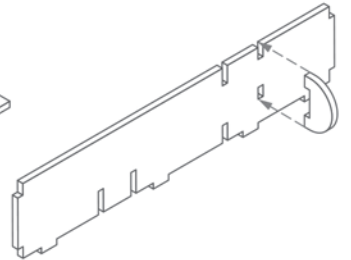

Step 4

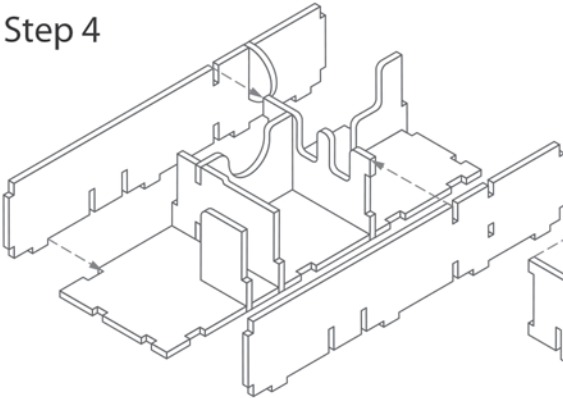

Step 5

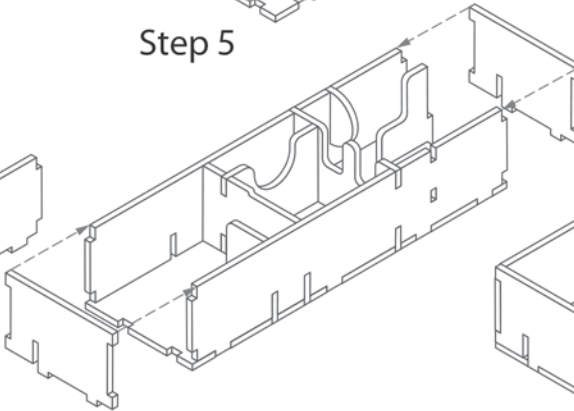

Finished tray

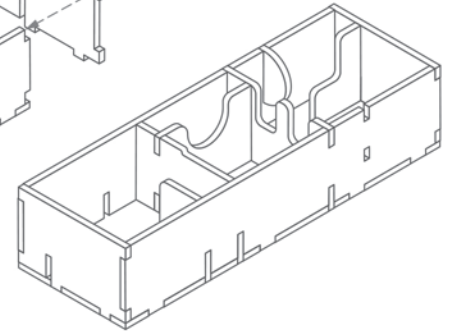

Tray 13a, 13b & 13c (the trays are identical)

Sheet E-I

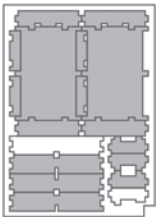

Sheet E-II

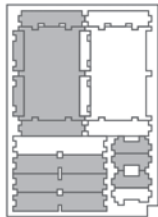

Step 1

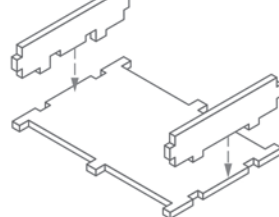

Step 2

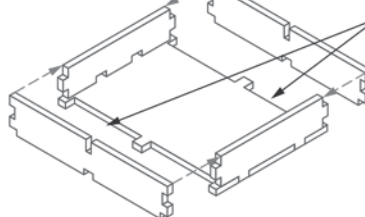

Note: There is a 4mm gap between the base and the long side walls.

Step 3

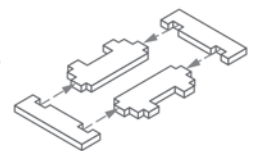

Sheet B-I

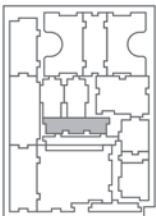

Sheet B-II

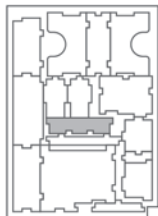

Sheet D

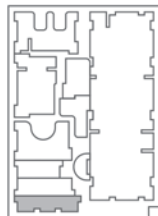

Step 4

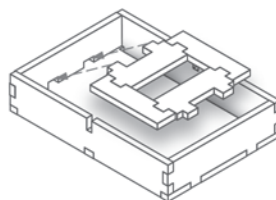

Step 5

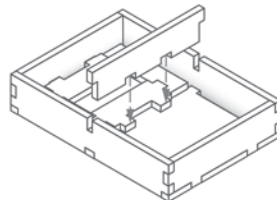

Finished tray

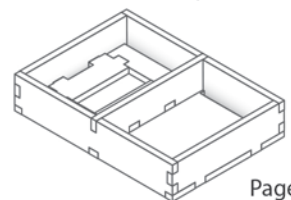

Tray 14

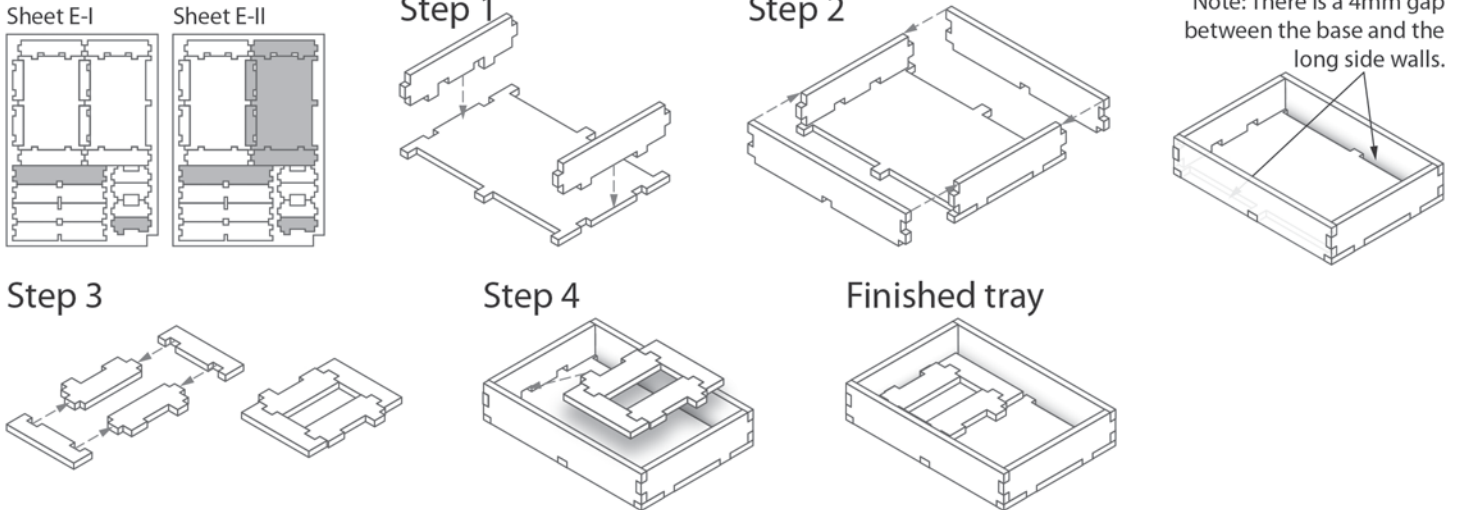

FS-RIS

Bottom Layer

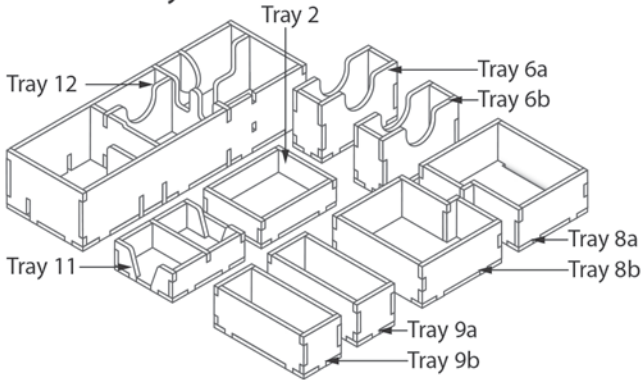

Tray legend:

- Tray 1a - coins
- Tray 1b - ronin tokens
- Tray 2 - war number banners
- Tray 3 - province tokens
- Tray 4 - bases and clan markers
- Tray 5 - Turtle clan
- Tray 6a, b - season cards
- Tray 7 - alliance markers
- Tray 8a, b - large monsters
- Tray 9a, b - turtle strongholds
- Tray 10 - strongholds
- Tray 11 - political mandates
- Tray 12 - huge monsters, shrine tiles
- Tray 13a - Bonsai clan
- Tray 13b - Koi clan
- Tray 13c - Lotus clan
- Tray 14 - Dragonfly clan

Mid Layer

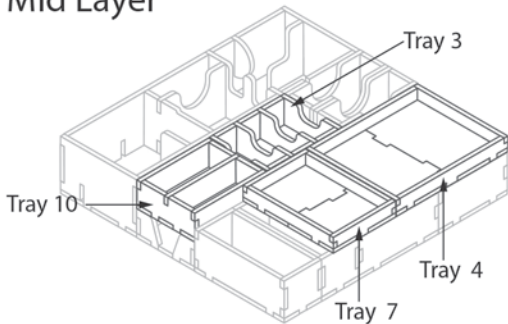

Note: While this insert does provide for vertical storage, the game contains many miniatures with protruding weapons that are liable to bend. We recommend for this reason to store the game horizontally.

Please check www.foldedspace.net for photos of this insert in use.

Top Layer

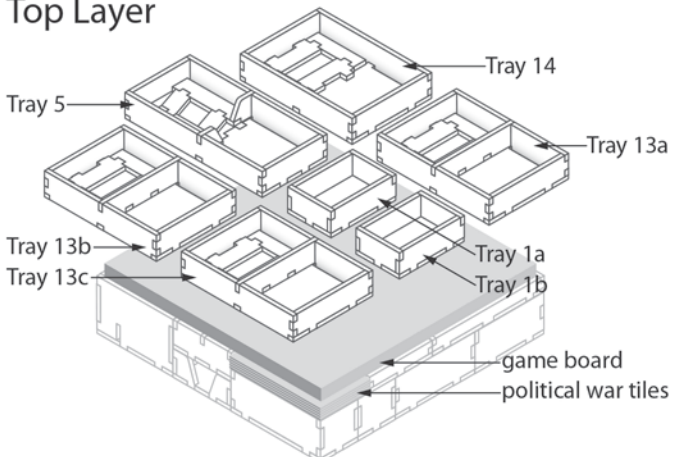

Finished Insert

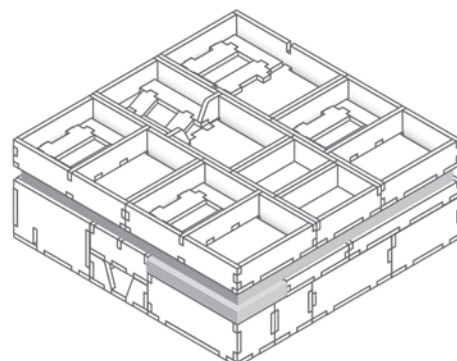

Tip:
Keep the instructions in the bottom of your board game box as a reminder of how the insert fits together.